

*The*  *Roadster*

CATALOGUE OF  
SPARE PARTS

From Chassis No. 4. AD I. U.

||||

Car Number including prefix and suffix  
letters must be quoted on all orders

||||

Issued by  
**SINGER MOTORS LTD.**  
COVENTRY AND BIRMINGHAM      ENGLAND

*Date of Issue, August 1951*



*Automotive Ltd.  
PRO 7636-8  
40-18 Upper Richmond Rd.  
East Sheen  
Lond S.W. 14*

*The*  *Roadster*

CATALOGUE OF  
SPARE PARTS

From Chassis No. 4. AD I. U.



Car Number including prefix and suffix  
letters must be quoted on all orders



Published by  
**SINGER MOTORS LTD.**  
COVENTRY AND BIRMINGHAM · ENGLAND

*Date of Issue, August 1951*

## INTRODUCTION

**T**O ensure correct parts being sent, and to avoid delay through inaccurate interpretation of Orders, it is essential to quote the following details:—

- (a) **CAR NUMBER**: Stamped on Plate, fixed on Bulkhead under Off-side of Bonnet. When quoting Car Number, please ensure that both "Prefix" and "Suffix" letters are given.
- (b) **YEAR OF MANUFACTURE AND HORSEPOWER**.
- (c) **ENGINE NUMBER**: On the Offside of the Cylinder Block Flywheel Housing.
- (d) **OFFSIDE OR NEARSIDE—FRONT OR REAR**: Position should be stated in applicable cases.
- (e) **RIGHT-HAND OR LEFT-HAND DRIVE**: All orders for Left-Hand Drive should be specifically marked, the abbreviation "L.H.D." being sufficient.

**PATTERNS**: In cases of doubt, it is advisable to forward patterns, to which the Name and Address of the sender should be securely attached and any reference such as Order Number etc., quoted.

A separate letter of advice is recommended. Patterns will not be returned with the replacements unless instructions to that effect accompany the Order, and will be destroyed unless claimed within 14 days after despatch of replacements.

**DRAWING NUMBERS AND FULL DESCRIPTION OF PARTS REQUIRED SHOULD BE STATED IN ALL ORDERS SENT BY POST.**

**IN TELEGRAPHIC OR CABLE ORDERS THE DRAWING NUMBER AND QUANTITY IS SUFFICIENT.** As an example: In cabling for four Pistons complete, the cable should read: "Singer, Coventry Four C.9939A, Name and Address".

**PAYMENT**: In view of the difficulties inherent in Credit booking on a large scale, goods (in the absence of an approved ledger account) must be paid for on or before delivery. To facilitate despatch, all goods will be sent C.O.D., in accordance with the Post Office Regulations. Where this is not possible, a Pro Forma Invoice will be submitted, if the order is not accompanied by a remittance to cover the cost of part or parts, plus transit charges.

Stocks of Parts are held by our Distributors and Dealers and your enquiries should be made to the appointed Distributor or Dealer covering your area.

In the event of any difficulty, please communicate direct to:—

**COVENTRY SERVICE DEPOT**  
**Raglan Street - - Coventry**

*Telegrams*: "Singer, Coventry"

*Telephone*: Coventry 5071

# GUARANTEE

## Warranty.

THE Company warrants that in the manufacture of new vehicles it has taken all precautions which are usual and reasonable to secure excellence of materials and workmanship and undertakes that if any defect is disclosed in any part of a new vehicle within six months of the date of delivery of such vehicle to the retail customer it will (provided such defective part is returned to the Works Carriage Paid) examine the part alleged to be defective and if on such examination the fault is found to be due to defective materials or workmanship for which it is responsible it will repair or replace the defective part free of charge.

This Warranty is given in respect of a vehicle purchased by the retail customer as a new vehicle, for which the Company's full retail List Price has been paid.

The foregoing Warranty is limited to new vehicles manufactured by the Company and is in lieu of any Warranty (or Condition) whether expressed or implied by Common Law Statute or otherwise as to the description quality or fitness for their purpose of any goods manufactured replaced or repaired by the Company every such Warranty (or Condition) whether expressed or implied being in all cases excluded and the liability of the Company under the terms of this Warranty is strictly limited to the replacement or repair and despatch to the Sender carriage forward of the part replaced or repaired. The Company shall not be responsible for any other liability expenses damages or loss which may occur consequent upon any misdescription, defective material or workmanship of any description.

The Warranty shall not apply to any defects caused by or arising in the following circumstances and in which instances all other Warranties (or Conditions) whether expressed or implied by Common Law Statute or otherwise are also expressly excluded.

This warranty shall not apply to defects caused or arising under the following conditions:—

- (a) During or caused by motor racing.
- (b) Wear and tear accident misuse or neglect.
- (c) Defects in any vehicle which has been altered in any manner whatsoever or upon which the identification numbers have been altered or removed.
- (d) Defects in any vehicle which has been or is let out on hire.

This Warranty shall be construed as including and shall be limited in its application to—

- (a) New vehicles or goods manufactured by the Company and which are bought direct from the Company or from one of its duly authorised Distributors, Dealers or Retail Dealers.
- (b) Repairs done or replacements supplied by the Company direct,

and all other Warranties (or Conditions) whether express or implied by Common Law Statute or otherwise are excluded. The Company gives no Warranty of any description in respect of any Secondhand Vehicles or goods sold by it or by its authorised Dealers or by any other person nor is any Warranty (or Condition) expressed or implied whether arising by Common Law Statute or otherwise in respect of such vehicles or goods.

All agreements and quotations by the Company to supply goods execute repairs or make replacements shall be deemed to include the above Warranty and the exclusion of all expressed or implied Warranties and/or Conditions.

The Company does not warrant the Specialities of other manufacturers fitted to its vehicles such as tyres, electrical fittings, lamps and horns. It endeavours to secure the best quality in these articles and the Makers whose names usually appear thereon are generally willing to replace any defective part. The Company will be pleased at all times to furnish the Maker's name and address.

## Conditions of Warranty.

If a defective part be found in any vehicle or goods it must be sent to the Company's Works carriage paid and accompanied by an intimation from the sender in writing that he desires to have it repaired or replaced free of charge under the Warranty. The sender must also furnish at the same time

- (a) The number of the car.
- (b) The name of the dealer if any from whom the car was purchased.
- (c) The date of the purchase of the car or the date when the repairs were executed or replacements made as the case may be.
- (d) The Mileage or Kilometres run.

The sender shall accept the Company's decision as final and conclusive on all claims for replacement of or repairs to defective material and/or workmanship and to the exchange of defective parts.

If these conditions are not strictly complied with the goods received by the Company will be at the risk of the Sender and this Warranty shall not be enforceable.

The Company shall not be responsible for the cost of any labour involved in connection with the removal or replacement of any defective parts from or to the vehicle.

## Repairs and Replacements.

All parts sent for repair or replacement must be forwarded carriage paid and bear the sender's name and address; the car number and year of manufacture should also be given. The foregoing Warranty is given by the Company in respect of all repairs to vehicles or parts of vehicles executed by it or replacements supplied by it direct but for three months only and subject nevertheless to the reservations limitations and conditions therein contained and all other conditions or warranties whether expressed or implied by Common Law Statute or otherwise are excluded. The Company shall not be responsible for any other liability expenses damages or loss which may occur consequent upon any misdescription defective material or workmanship of any description in connection with any replacements supplied or repairs executed by it.

The Company accepts no responsibility whatsoever for any replacements or parts which are not fitted by it to a vehicle even if such replacements or parts are supplied by it.

Cars which are sent for repairs will only be driven by the Company's employees at the risk and responsibility of the owners and repairs of cars are undertaken only on the assumption that the owners give authority to drive the cars on their behalf. The Company accepts no responsibility for damage by fire or otherwise to customers' cars or parts thereof whilst on the Company's premises.

SINGER MOTORS LIMITED, COVENTRY.

## CONDITIONS OF SALE

**A**LL new cars and chassis and parts thereof manufactured by SINGER MOTORS LIMITED (hereinafter referred to as "the Company") are sold subject to but with the benefit of the Conditions of Sale hereinafter set forth, and this is so whether the sale is (a) by the Company to a Distributor, Dealer or Retail Dealer, or (b) by the Company direct to the user, or (c) by Distributor or Dealer to a Trader, or (d) by a Distributor, Dealer, Retail Dealer or Trader, to the user:—

1. **GUARANTEE.** The Company's Guarantee, a copy of which is enclosed herein, shall be deemed to be incorporated in these Conditions: to the intent, in the case of a sale by a Distributor, Dealer, Retail Dealer or Trader that he shall pass on the benefit of the Guarantee to his purchaser, who shall be subject to its obligations; but such transfer of the benefit of the Guarantee shall not create any privity of contract between the Company and such purchaser; and every Distributor, Dealer, Retail Dealer and Trader contracts as a principal and not as an agent, and has no authority to give any warranty or make any representation or otherwise act on behalf of the Company.

2. **PRICE AND PAYMENT.** Prices quoted are for delivery at the Company's Works at Birmingham, net cash on delivery. Freightage therefrom to the depot of a Distributor, Dealer, Retail Dealer or Trader is extra.

3. **DELIVERY.** Neither the Company nor any Distributor, Dealer, Retail Dealer or Trader shall be liable for any delay in delivery on the part of the Company (whatever the cause of such delay), nor for any damage caused thereby.

4. **ALTERATIONS IN PRICE AND CONDITIONS.** The Company's prices and Conditions of Sale may be altered at any time without notice, and all cars and chassis and parts therefore are sold subject to the prices and Conditions of Sale ruling at the time of delivery.

In the event of increase of price, however, a purchaser may in writing cancel his order within seven days of receiving notice of the increase.

5. **ALTERATIONS IN SPECIFICATION.** The Company's specifications may be altered at any time without notice; and in such event the seller may cancel any order, or goods conforming to the altered specification may be delivered in fulfilment of such order unless, in the case of substantial alterations, the purchaser in writing cancels that order within seven days of receiving notice of the intention to deliver in conformity with the altered specification.

6. **SPARE PARTS.** When ordering spare parts, it is essential that the identification number thereof, as shown in the Company's Spare Parts List, should be given, as well as the chassis and engine number of the car for which they are required.

7. **DISTRIBUTORS AND DEALERS.** (a) Every Distributor, Dealer, Retail Dealer and Trader shall incorporate these Conditions in any contract it makes with a purchaser, either by reference or by setting them out in extenso in the order form. Where such incorporation is by reference only, the Distributor, Dealer, Retail Dealer or Trader shall see that a copy of the Conditions is handed to such purchaser prior to the completion of the contract, and that such purchaser's attention is specifically drawn to them. (b) If any purchaser from a Distributor, Dealer, Retail Dealer or Trader shall commit a breach of these Conditions, the Distributor, Dealer, Retail Dealer or Trader shall, on being required by the Company or his Vendor so to do, take such steps as the Company may think fit, whether by instituting legal proceedings or otherwise, in order to enforce these Conditions.

8. **EXHIBITIONS AND COMPETITIONS.** No car or chassis or part thereof shall be exhibited at any exhibition or show or permitted to take part in any competition unless the same is held or approved by the Society of Motor Manufacturers and Traders Limited. Anyone who commits or allows a breach of these conditions renders himself liable to pay damages not exceeding £250.

9. **GENERAL.** (a) The Company may allocate any order placed direct with it to its authorised Distributor or Dealer in the appropriate territory. (b) These Conditions and any contract to which these Conditions apply shall be construed according to English Law.

# GROUP INDEX

	<i>Page</i>		<i>Page</i>
<b>ENGINE.</b>		<b>BRAKES.</b>	
Engine Case .. .. .	18	Balance Levers—Operating Rods .. ..	46
Crankshaft .. .. .	18	Front Brake Serviceable Parts .. ..	46
Connecting Rods and Pistons .. .. .	18	Rear Brake Serviceable Parts .. .. .	47
Intermediate Timing Gear and Chains ..	19	<b>PROPELLER SHAFT.</b>	
Rocker Oil Feed Pipe—Oil Relief Valve— Breather Tube .. .. .	20	Propeller Shaft .. .. .	48
Timing Gear Tensioner .. .. .	20	Propeller Shaft Serviceable Parts .. ..	48
Front and Rear Cover—Fan Pulley— Flywheel .. .. .	21	<b>FRAME.</b>	
Oil Pump Assembly—Oil Filter—Oil Sump	21	Frame Assembly .. .. .	49
Cylinder Head—Side Plate and Fittings ..	22	Master Cylinder—Supply Tank .. ..	49
Valves and Springs .. .. .	23	Master Cylinder Serviceable Parts .. ..	49
Water Outlet Pipe—Distribution Tube— Camshaft .. .. .	23	Rear Road Spring—Shock Absorber .. ..	50
Rocker Bar Assembly .. .. .	24	Brake Details .. .. .	50
Manifold and Bleed Pipe .. .. .	24	Hydraulic Pipes and Fittings .. .. .	51
Front Cover—Rocker Cover .. .. .	24	Brake Reversing Lever—Balance Lever ..	51
Water Pump and Fan .. .. .	25	Handbrake and Handbrake Lever .. ..	52
Accessories — Dynamo — Distributor — Starter—Carburettor .. .. .	26	Brake Coupling Lever—Brake Rods .. ..	52
<b>CLUTCH.</b>		Brake and Clutch Pedal Assemblies L.H.D.	53
Clutch Main Assembly—Housing—Release Bearing .. .. .	30	Clutch Pedal Rod and Brake Operating Levers L.H.D. .. .. .	53
Clutch Driving Plate Assembly .. .. .	30	Exhaust System .. .. .	54
<b>GEARBOX.</b>		Petrol Tank—Pipes—Fittings .. .. .	54
Gearbox Assembly .. .. .	31	Petrol Pump .. .. .	55
Layshaft Assembly .. .. .	31	Petrol Pump Serviceable Parts .. .. .	55
Reverse Gear—Selector Fork .. .. .	31	Radiator and Connections .. .. .	56
Mainshaft and Gears .. .. .	32	Road Wheels .. .. .	56
Rear End Cover and Speedometer Gears ..	32	<b>ELECTRICAL EQUIPMENT.</b>	
Top Cover .. .. .	33	Instruments — Controls — Battery — Side Lamps .. .. .	57
Striker Gear .. .. .	33	Head Lamps .. .. .	58
Remote Control .. .. .	34	Serviceable Parts for Side Lamp, Wind- screen Wiper, Stop-Tail Lamp and Number Plate .. .. .	60
Change Speed Lever .. .. .	34	Oil Pressure Pipes .. .. .	61
Clutch Pedal .. .. .	34	<b>CHASSIS FITTINGS.</b>	
<b>ENGINE MOUNTING.</b>		Accelerator Pedal .. .. .	62
Engine Mounting .. .. .	36	Front—Rear Bumpers .. .. .	62
<b>INDEPENDENT SUSPENSION.</b>		Front Wings—Bonnet Sides—Louvres— Stepboards .. .. .	63
Bottom Wishbone Assembly .. .. .	37	Front Wing Stays and Fitch Plates .. ..	63
Outer Support Bracket Assembly .. .. .	37	Rear Wings .. .. .	64
Top Arm Assembly .. .. .	37	Radiator Case—Grille .. .. .	65
Swivel Pins .. .. .	37	Bonnet Landings—Bonnet Top .. .. .	65
Swivel Levers .. .. .	38	<b>TOOLS.</b>	
Spring Bottom Carrier .. .. .	38	Tools .. .. .	66
Coil Spring Top Bracket—Coil Spring ..	38	<b>OPTIONAL EXTRAS.</b>	
Axle Swivel—Hub—Brake Drum .. .. .	39	<b>BODY.</b>	
Front Stabiliser Bar .. .. .	39	Body Shell .. .. .	66
Front Shock Absorbers .. .. .	39	Doors .. .. .	67
Front Brake Back Plate (Export) .. ..	40	Door Hinges—Locks—Handles .. .. .	67
<b>STEERING.</b>		Body Mounting .. .. .	68
Front Cross Tube .. .. .	40	Windscreen .. .. .	69
Steering Column .. .. .	41	Seats .. .. .	69
Steering Column Serviceable Parts .. ..	41	Floorboards .. .. .	69
Idler Lever—Tie Rods .. .. .	42	Carpets and Tread Plates .. .. .	70
Tie Rod Serviceable Parts .. .. .	42	Hood—Side Screens .. .. .	70
<b>REAR AXLE.</b>			
Rear Axle Assembly .. .. .	44		
Differential Serviceable Parts .. .. .	44		
Rear Axle Housing .. .. .	45		

# PLATE I

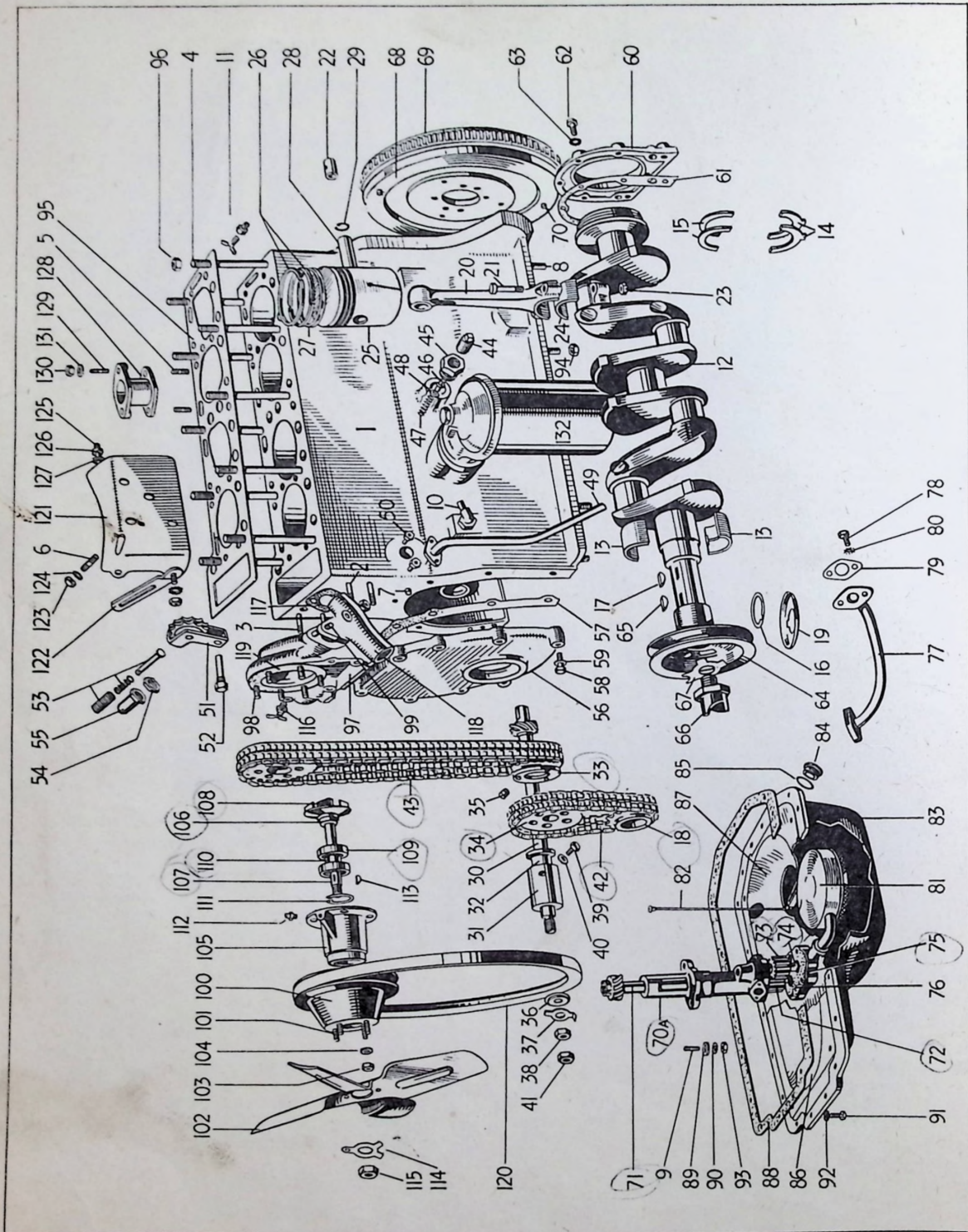



# PLATE 2

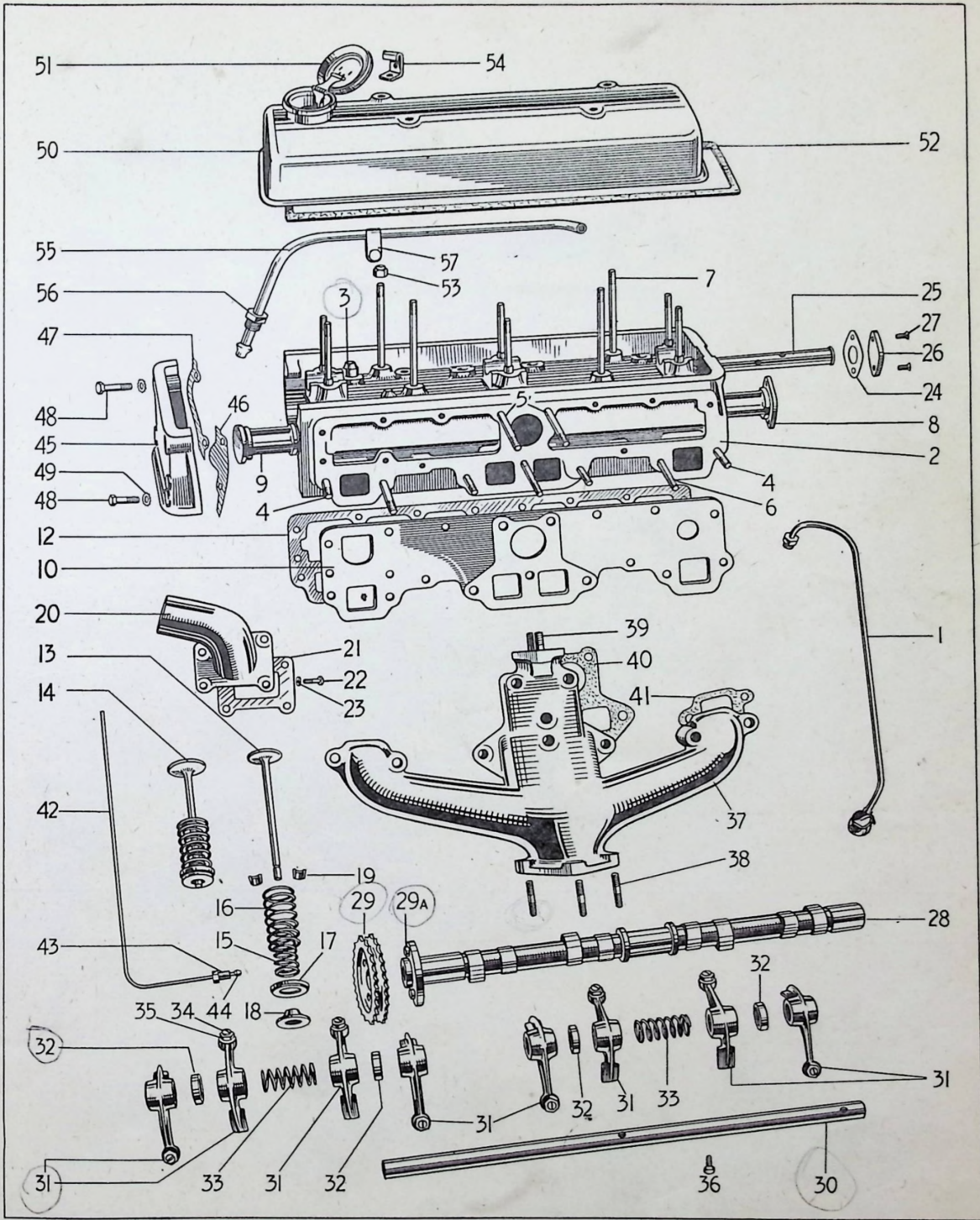

Plate 3

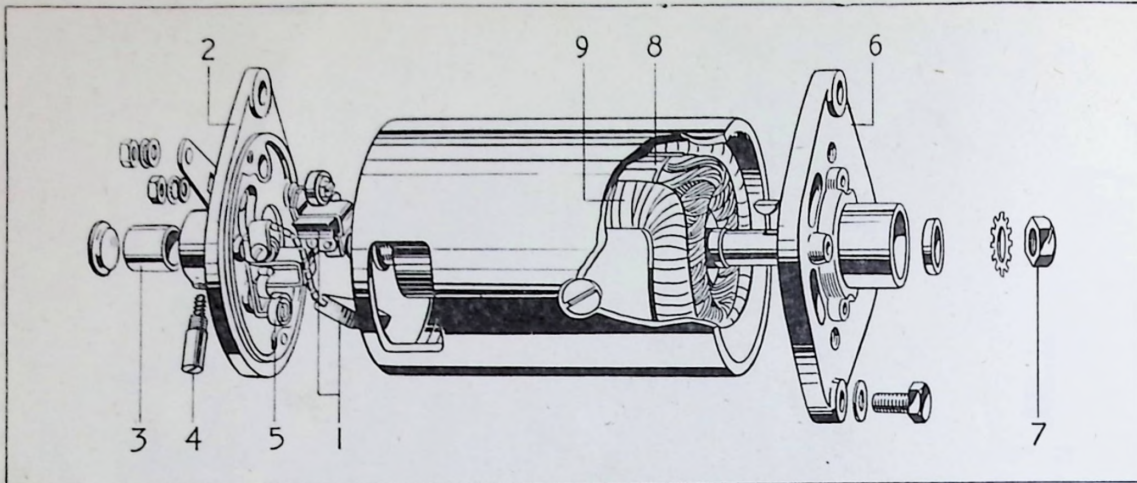

Plate 4

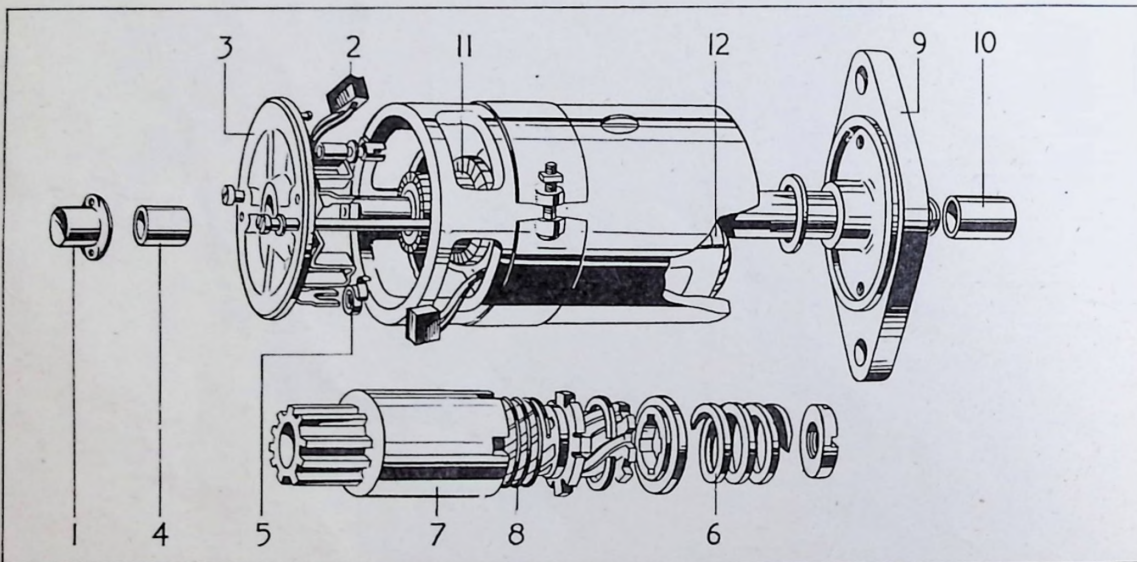
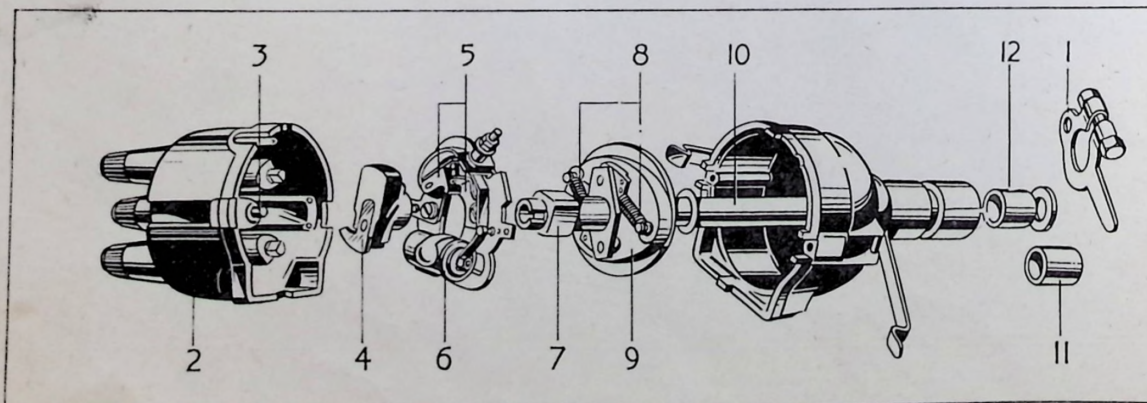
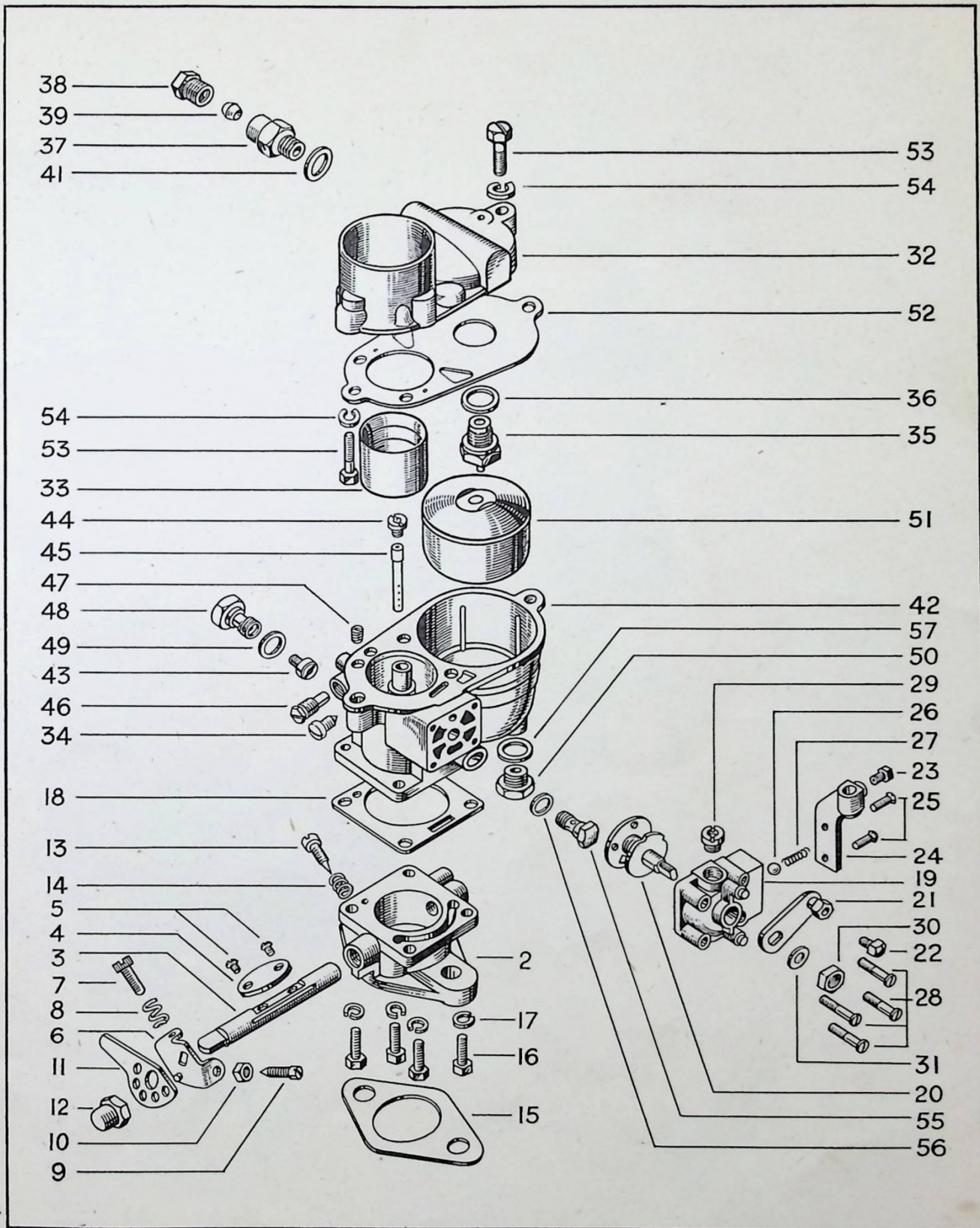

Plate 5



# PLATE 6



# PLATE 9

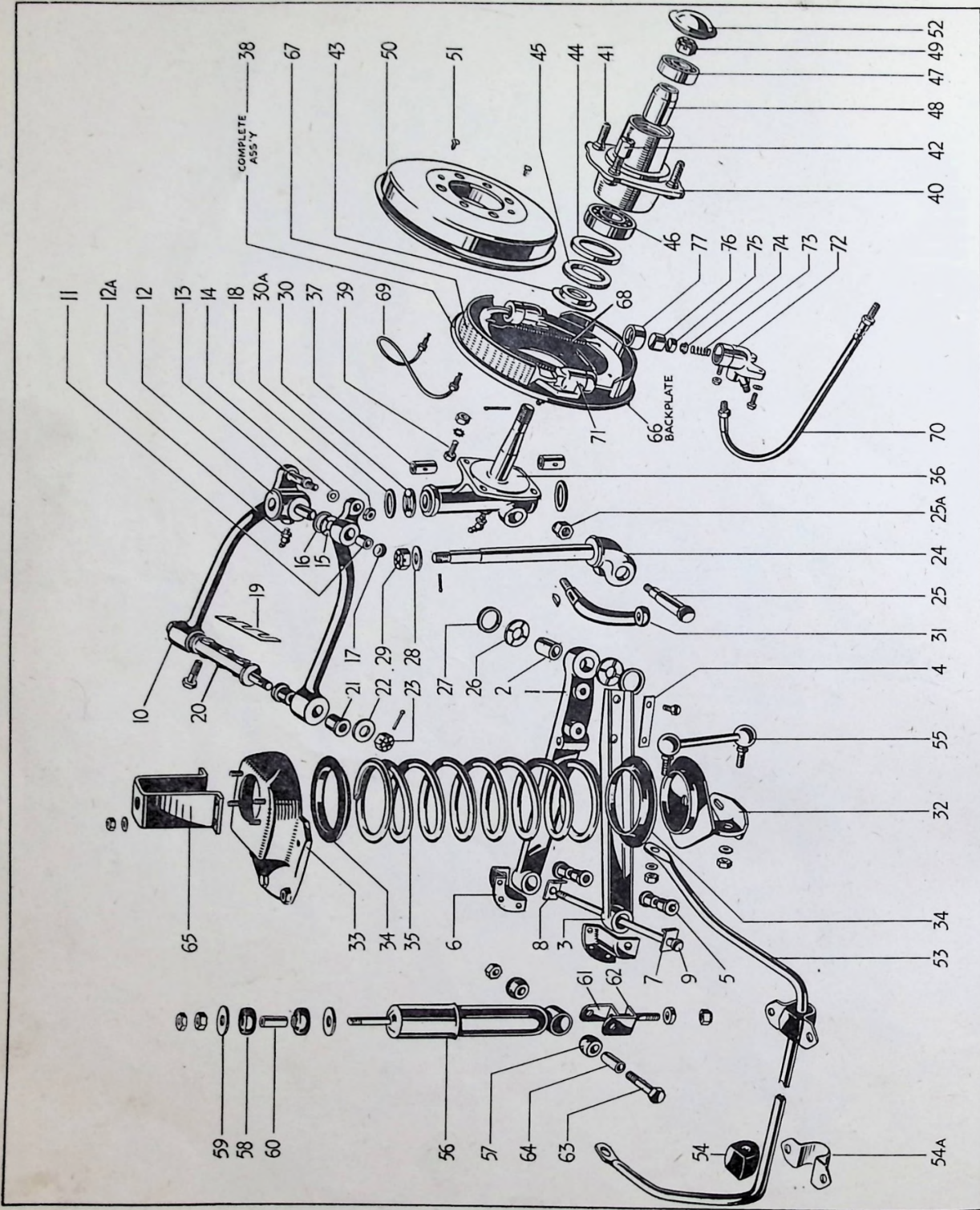

# PLATE 10

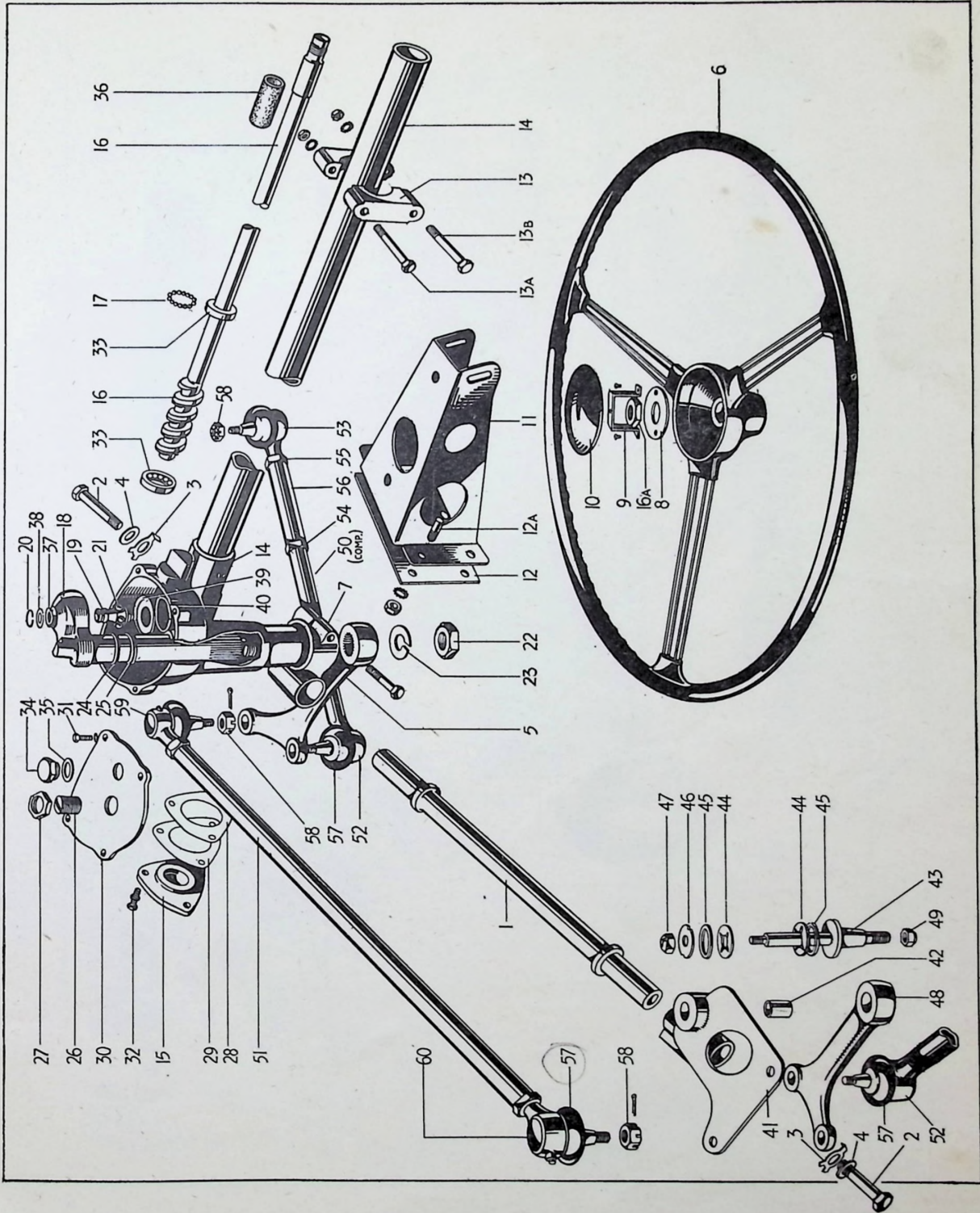

# PLATE II

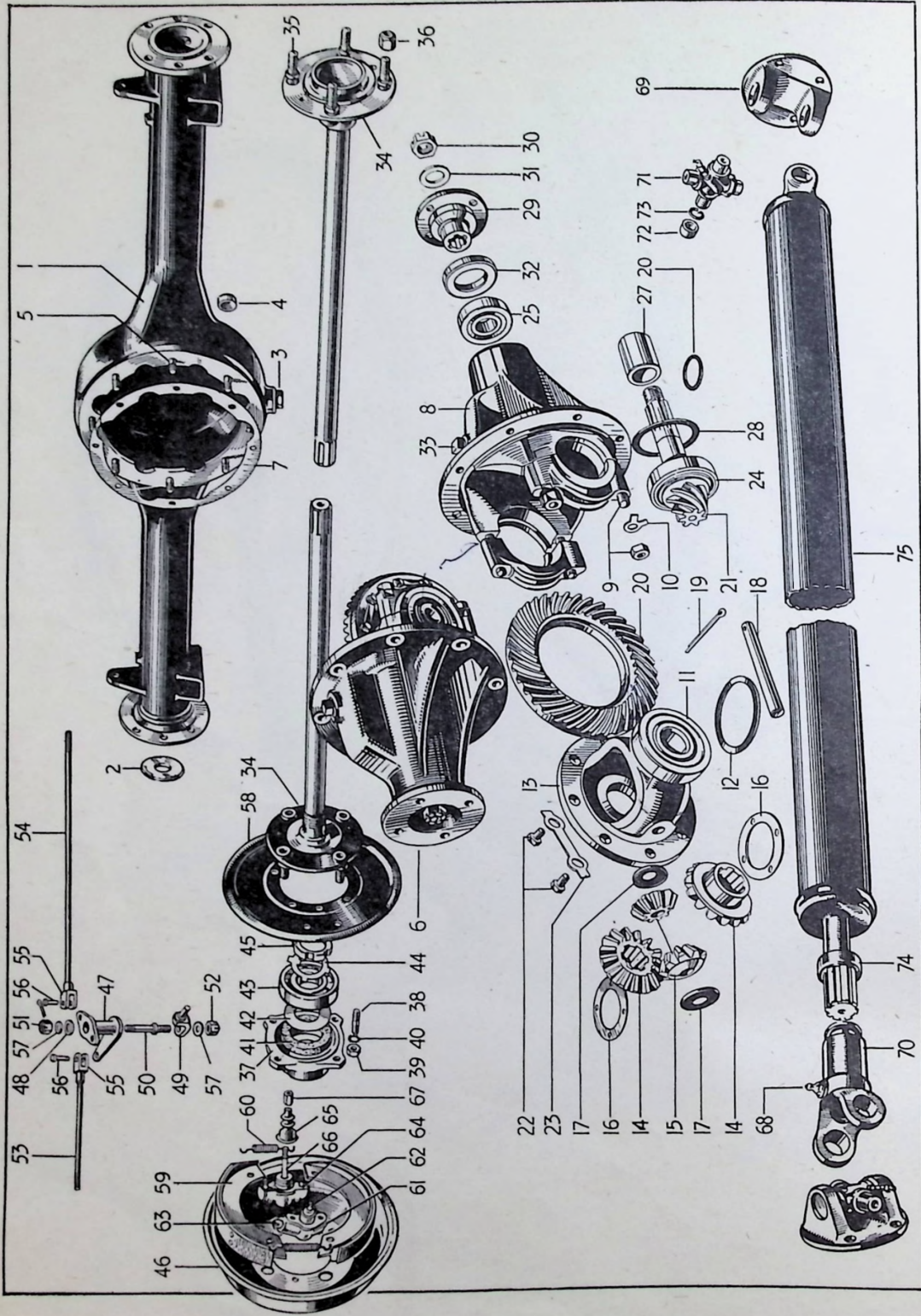

# PLATE 12

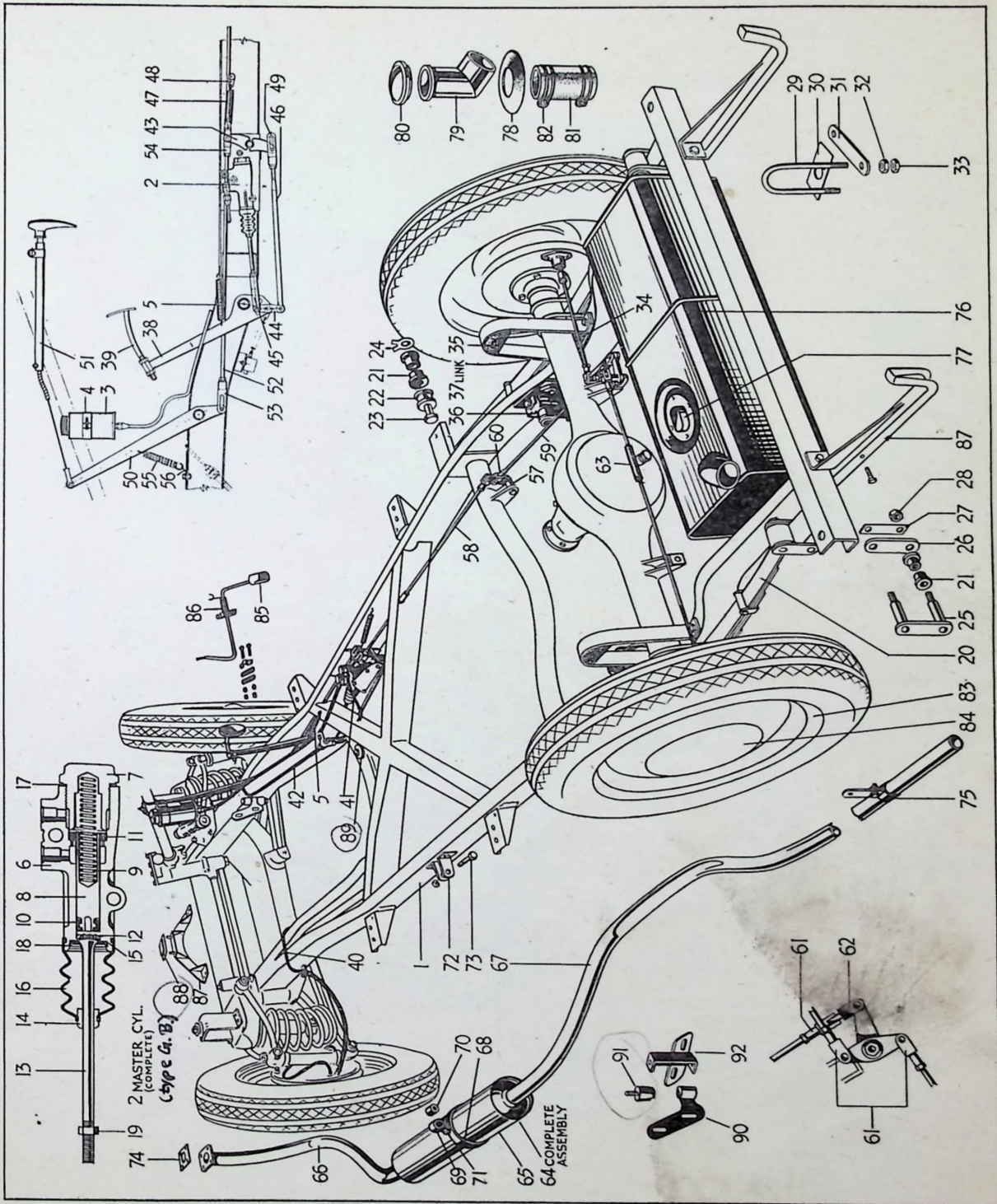

# PLATE 13

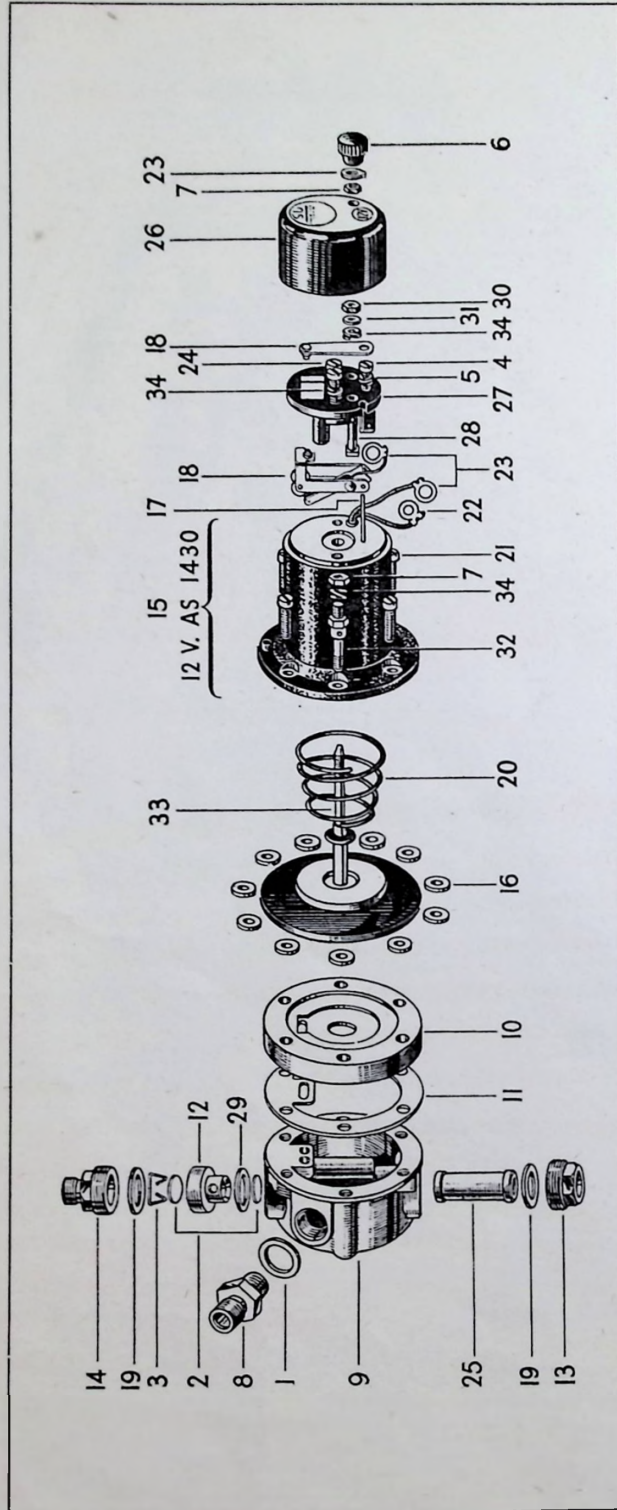



# PLATE 14

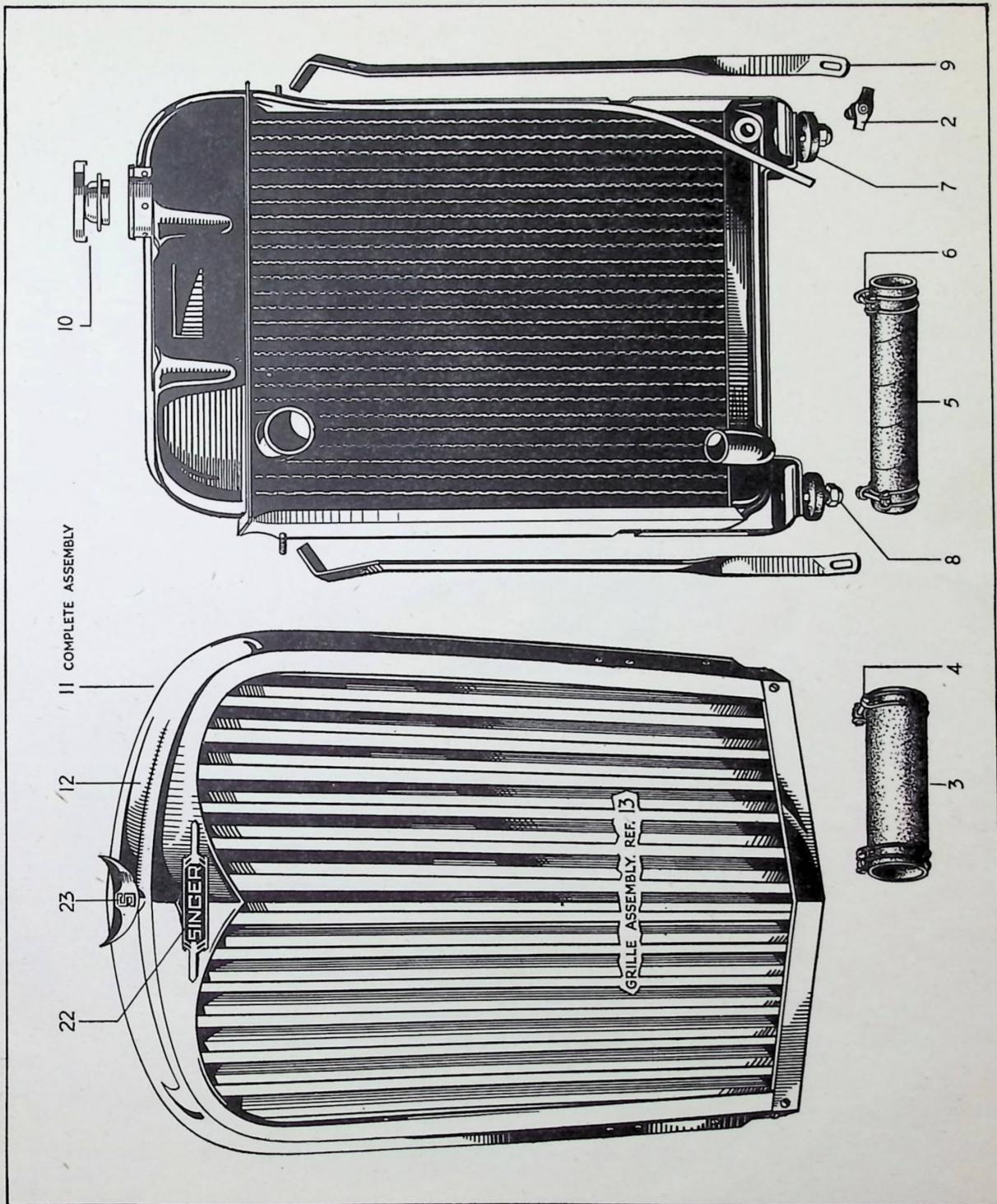

# ENGINE

PART No.	PLATE No.	PLATE REF.	DESCRIPTION	No. OFF		REMARKS
				R.H.D.	L.H.D.	
400561	1		<b>Engine Assembly Complete</b> ..	1	1	
C.10000 N.D.		1	Cylinder Block Studded Assembly ..	1	1	
C.9925			Cylinder Block only .. ..	1	1	
FST.7/26F			Studs : Crankshaft Bearing Caps ..	6	6	
C.6319			Dowels : Crankshaft Bearing Caps ..	6	6	
$\frac{7}{16}$ " B.S.F.			Simmonds Nut : Crankshaft Bearing Caps .. .. .	6	6	Replaced by N.107L and C.10428 in sets
N.107L			Nut : Bearing Caps .. .. .	6	6	
C.10428			Tabwasher : Crankshaft Bearing Cap ..	6	6	
C.6347			Dowel : Rear Cover .. .. .	2	2	
C.6388			Plug : Oil Gallery—Front .. .. .	2	2	
C.6526			Oil Gallery Plug : Side.. .. .	1	1	
C.6493			Dowel for Clutch Housing .. .. .	2	2	
FST.6/19F		2	Stud : Water Pump to Cylinder Block ..	3	3	
FST.7/41F		4	Stud : Cylinder Head to Block .. ..	10	10	
FST.4/6		5	Stud : Distributor .. .. .	2	2	
C.6519		7	Dowel : Front Cover .. .. .	2	2	
FST.4/6		8	Stud : Oil Sump .. .. .	6	6	
FST.4/6		9	Stud : Oil Sump Trays to Block .. ..	4	4	
FST.5/12			Stud : Oil Pump to Block .. .. .	2	2	
FST.4/6			Stud : Coil to Cylinder Block .. .. .	2	2	
C.9831			Water Jacket Plate .. .. .	4	4	
C.9227		11	Tap : Water Drain .. .. .	1	1	
<b>CRANKSHAFT.</b>						
C.8350C		12	Crankshaft .. .. .	1	1	
C.6347			Dowel : Crank to Flywheel .. .. .	2	2	
C.7629		13	Bearings (Standard) Crankshaft) ..	6	6	
C.7629/3			Bearings (—.003" Undersize) Crankshaft	6	6	
C.7629/10			Bearings (—.010" Undersize) Crankshaft	6	6	
C.7545		14	Crankshaft Thrust Washer : Top and			
		15	Bottom Half .. .. .	2	2	
C.7733		16	Shim : Crankshaft—Front .003" ..	as required		
C.7734			Shim : Crankshaft—Front .005" ..	as required		
C.7735			Shim : Crankshaft—Front .015" ..	as required		
Woodruff No. 9		17	Key : Crankshaft Timing Wheel ..	1	1	
C.7675			Timing Wheel : Crankshaft .. .. .	1	1	
C.7703			Oil Thrower : Crankshaft .. .. .	1	1	
<b>CONNECTING RODS AND PISTONS</b>						
C.7413A		20	Connecting Rod and Cap Assembly ..	4	4	
C.7541		21	Bolt : Connecting Rod .. .. .	8	8	
$\frac{3}{8}$ " B.S.F.		23	Simmonds Nut : Connecting Rod .. ..	8	8	Replaced by N.106L and C.10410 in sets

## ENGINE

PART No.	PLATE No.	PLATE REF.	DESCRIPTION	NO. OFF R.H.D.	NO. OFF L.H.D.	REMARKS
N.106L	1		Nut : Connecting Rod .. .. .	8	8	
C.10410			Tabwasher : Connecting Rod Bolt ..	8	8	
C.7689		22	Bush : Gudgeon Pin .. .. .	4	4	
C.7630		24	Bearings (Standard) : Connecting Rod	8	8	
C.7630/3			Bearings (— .003" Undersize) : Con-			
			necting Rod .. .. .	8	8	
C.7630/10			Bearings (— .010" Undersize) : Con-			
			necting Rod .. .. .	8	8	
C.9939A		25	Piston Assembly (Standard) .. .. .	4	4	
C.9939A/5			Piston Assembly (+ .005" Oversize) ..	4	4	
C.9939A/15			Piston Assembly (+ .015" Oversize) ..	4	4	
C.9939A/30			Piston Assembly (+ .030" Oversize) ..	4	4	
C.8989		26	Compression Ring (Standard) Plain ..	4	4	
C.8989/5			Compression Ring (+ .005" Oversize)			
			Plain .. .. .	4	4	
C8989/15			Compression Ring (+ .015" Oversize)			
			Plain .. .. .	4	4	
C.8989/30			Compression Ring (+ .030" Oversize)			
			Plain .. .. .	4	4	
C.8990			Compression Ring (Standard) Stepped ..	4	4	
C.8990/5			Compression Ring (+ .005" Oversize)			
			Stepped .. .. .	4	4	
C.8990/15			Compression Ring (+ .015" Oversize)			
			Stepped .. .. .	4	4	
C.8990/30			Compression Ring (+ .030" Oversize)			
			Stepped .. .. .	4	4	
C.8991		27	Scraper Ring (Standard) .. .. .	4	4	
C.8991/5			Scraper Ring (+ .005" Oversize) ..	4	4	
C.8991/15			Scraper Ring (+ .015" Oversize) ..	4	4	
C.8991/30			Scraper Ring (+ .030" Oversize) ..	4	4	
C.7711 N.D.		28	Gudgeon Pin (Standard) .. .. .	4	4	
C.7711/3 N.D.			Gudgeon Pin (+ .003" Oversize) ..	4	4	
C.7712 N.D.		29	Circlip : Gudgeon Pin .. .. .	8	8	
<b>INTERMEDIATE TIMING GEAR AND CHAINS.</b>						
C.7602		30	Intermediate Timing Shaft .. .. .	1	1	
C.7570A			Bush Assembly : Timing Shaft ..	1	1	
C.7570		31	Bush : Timing Shaft .. .. .	1	1	
C.7571		32	Bush : Timing Shaft .. .. .	2	2	
C.7676		33	Chain Wheel (Driver) : Inter. Shaft ..	1	1	
Woodruff No. 6			Key .. .. .	1	1	
C.7677		34	Chain Wheel (Driven) : Inter. Shaft ..	1	1	
C.6379		35	Drive Pin : Chain Wheel .. .. .	3	3	
C.3521		36	Washer : Chain Wheel .. .. .	1	1	
C.3410		37	Tabwasher : Inter. Timing Shaft ..	1	1	

## ENGINE

PART No.	PLATE No.	PLATE REF.	DESCRIPTION	No. OFF		REMARKS
				R.H.D.	L.H.D.	
N.108K	1	38	Nut : Inter. Timing Shaft .. ..	1	1	
C.3398		39	Locating Screw : Inter. Timing Shaft ..	1	1	
C.3986		40	Locating Washer : Inter. Timing Shaft	1	1	
N.107K		41	Locating Nut : Inter. Timing Shaft ..	1	1	
Reynolds No. 114038		42	Intermediate Chain, Primary (.375" P. 46 Pitches) .. .. .	1	1	
Reynolds No. 114038		43	Intermediate Chain, Secondary (.375" P. 86 Pitches) .. .. .	1	1	
<b>ROCKER OIL FEED PIPE, RELIEF VALVE—BREATHER TUBE</b>						
C.9953A	2	1	Rocker Oil Feed Pipe Assembly ..	1	1	
C.6640			Tubing Nut : Rocker Oil Feed Pipe Assembly .. .. .	1	1	
C.6641			Tubing Sleeve : Rocker Oil Feed Pipe ..	1	1	
C.6805			Feed Pipe Banjo .. .. .	1	1	
C.3944			Tabwasher : Rocker Oil Feed Pipe ..	1	1	
C.3948			Feed Pipe Setscrew .. .. .	1	1	
C.6974			Sealing Washer : Banjo .. .. .	2	2	
C.6321	1	44	Oil Relief Valve Plug .. .. .	1	1	
C.6428		45	Nut : Oil Relief Valve Plug .. .. .	1	1	
C.9087		46	Oil Relief Valve .. .. .	1	1	
C.8417		47	Spring : Oil Relief Valve .. .. .	1	1	
C.6646		48	Washer : Oil Relief Valve .. .. .	1	1	
C.8557		49	Breather Tube Assembly .. .. .	1	1	
C.8561			Washer : Breather Tube .. .. .	1	1	
F.S.104/4		50	Set Pin : Breather Tube Assembly ..	2	2	
1/4" Dia. Ext. 400755			Washer (Shakeproof) .. .. .	2	2	
C.7470			Breather Tube Extension .. .. .	1	1	
C.9893			Rocker Oil Feed Pipe Clip .. .. .	1	1	
F.B.104/9			Rocker Oil Feed Pipe Distance Piece Clip	1	1	
C.6541			Rocker Oil Feed Pipe Clip Bolt .. ..	1	1	
W.104/K			Rocker Oil Feed Pipe Clip Washer ..	2	2	
1/4" B.S.F. GKN. EA1			Rocker Oil Feed Pipe Clip Washer ..	1	1	
			Rocker Oil Feed Pipe Clip Nut ..	1	1	
<b>TIMING GEAR TENSIONER</b>						
C.10126		51	Tensioner Sprocket and Arm Assembly	1	1	
C.10124			Tensioner Sprocket Assembly .. ..	1	1	
C.7991			Pivot Bush : Chain Tensioner .. ..	1	1	
C.10123			Sprocket : Chain Tensioner .. .. .	1	1	
C10125			Bush : Tensioner Sprocket .. .. .	1	1	

# ENGINE

PART No.	PLATE No.	PLATE REF.	DESCRIPTION	No. OFF		REMARKS
				R.H.D.	L.H.D.	
C.7992	1		Pin, Sprocket : Chain Tensioner ..	1	1	
C.7764		52	Pivot Pin : Chain Tensioner .. ..	1	1	
C.7993			Tabwashers for Pivot Pin .. ..	1	1	
C.7985		53	Plunger Assembly : Chain Tensioner ..	1	1	
C.7987B			Spring : Chain Tensioner .. ..	1	1	
N.208K		54	Locknut : Chain Tensioner Adjuster ..	1	1	
7989		55	Cover : Chain Tensioner Adjuster ..	1	1	
<b>FRONT AND REAR COVERS—FAN PULLEY—FLYWHEEL.</b>						
C.7664		56	Front Cover : Cylinder Block .. ..	1	1	} First Pattern may be serviced by following seven items if dowel C.6519 is removed from cylinder block
C.7674		57	Washer : Front Cover—Cylinder Block	1	1	
F.B.104/8		58	Bolt : Front Cover to Block .. ..	8	8	
W.104/K		59	Washer : Front Cover to Block .. ..	8	8	
C.10176		56	Front Cover Cylinder Block .. ..	1	1	
C.10177			Front Cover Cylinder Retaining Bracket	1	1	
C.10178		57	Front Cover Cylinder Washer .. ..	1	1	
FB.104/10			Bolt : Front Cover to Block .. ..	2	2	
FB.104/4			Set Pin : Front Cover to Block .. ..	6	6	
FS.104/4			Retaining Bolt : Cover to Block .. ..	1	1	
1/4" Dia. Ext.			Shakeproof Washer .. ..	9	9	
C.7610		60	Rear Cover : Cylinder Block .. ..	1	1	
C.7673		61	Washer : Rear Cover .. ..	1	1	
FB.104/8		62	Bolt : Rear Cover to Block .. ..	6	6	
1/4" Dia. Ext.		63	Washer (Shakeproof) .. ..	6	6	
C.8196		64	Fan Pulley : Crankshaft .. ..	1	1	
Woodruff No. 9 N.D.1230		65	Key : Fan Pulley .. ..	1	1	
C.9979		66	Starting Dog .. ..	1	1	
C.7706		67	Lockwasher : Starting Dog .. ..	1	1	
C.7683D		68	Flywheel Assembly .. ..	1	1	
C.7683B			Flywheel .. ..	1	1	
C.9692		69	Starter Ring : Flywheel .. ..	1	1	
FB.106/8F			Fixing Bolt : Flywheel .. ..	4	4	
C.3053		70	Dowel : Flywheel to Clutch .. ..	2	2	
C.7707			Lockwasher : Flywheel Fixing Bolt ..	2	2	
<b>OIL PUMP ASSEMBLY—OIL FILTER.</b>						
400443 N.D.			Oil Pump Assembly .. ..	1	1	
C.7546		70A	Body : Oil Pump .. ..	1	1	
C.7555		71	Shaft : Oil Pump and Distributor Drive	1	1	

## ENGINE

PART No.	PLATE No.	PLATE REF.	DESCRIPTION	No. OFF		REMARKS	
				R.H.D.	L.H.D.		
C.7557	1	72	Wheel (Driver) : Oil Pump .. ..	1	1		
C.7558		73	Wheel (Driven) : Oil Pump .. ..	1	1		
Woodruff No. 3				Key .. ..	1	1	
C.7559		74	Shaft : Oil Pump Wheel .. ..	1	1		
C.7556				Distance Piece : Oil Pump Shaft ..	1	1	
400391		75	Cover Assembly : Oil Pump .. ..	1	1		
C.7564A		76	Washer : Oil Pump .. ..	1	1		
FS.104/4				Setscrew : Oil Pump Cover .. ..	2	2	
FB.104/8				Bolt : Oil Pump Cover .. ..	2	2	
$\frac{1}{4}$ " Dia. Ext. Simmonds				Shakeproof Washer : Oil Pump Cover	4	4	
$\frac{3}{8}$ " B.S.F. (NP F124)				Nut : Oil Pump Shaft .. ..	1	1	
N.105K				Nut : Oil Pump Body to Case .. ..	2	2	
$\frac{5}{16}$ " Dia. Ext.				Washer : Shakeproof .. ..	2	2	
400392				Oil Filter Cover .. ..	1	1	
400482				Oil Pump Filter Cage .. ..	1	1	
C.10132		77		Oil Pipe : Pump to Gallery Assembly ..	1	1	
FS.104/4		78		Setscrews : Pipe to Pump and Gallery	4	4	
C.7569		79		Washer : Oil Pump Flange .. ..	2	2	
$\frac{1}{4}$ " Dia. Ext.		80		Washer (Shakeproof) for Oil Pipe ..	4	4	
400397				Dipstick : Engine Oil Level .. ..	1	1	
<b>OIL SUMP.</b>							
C.7598A		83	Oil Sump Assembly .. ..	1	1		
C.8725		84	Drain Plug : Oil Sump .. ..	1	1		
C.6303		85	Washer : Oil Sump Drain Plug .. ..	1	1		
C.7600B		86	Tray : Oil Sump—Front .. ..	1	1		
C.7736B		87	Tray : Oil Sump—Rear .. ..	1	1		
C.7601		88	Washer : Oil Sump .. ..	1	1		
W.104K		89	Washer : Tray to Cylinder Block ..	4	4		
$\frac{1}{4}$ " Dia. Ext.		90	Washer (Shakeproof) : Tray to Cylinder Block .. ..	4	4		
FS.104/4		91	Setscrew : Oil Sump .. ..	15	15		
W.104K		92	Washer : Oil Sump .. ..	21	21		
N.104K		93	Nut : Tray to Cylinder Block .. ..	4	4		
N.104K		94	Nut : Oil Sump to Cylinder Block ..	6	6		
<b>CYLINDER HEAD.</b>							
400562	2	2	Cylinder Head, Studded Complete with Camshaft, Valves and Rockers, etc. ..	1	1		
C.8755 N.D.			Cylinder Head : Studded and Valve Guides .. ..	1	1		
N.105K			Nuts : Camshaft Bearings .. ..	6	6		
$\frac{5}{16}$ " Dia. Ext.			Washer (Shakeproof) .. ..	6	6		

# ENGINE

PART No.	PLATE No.	PLATE REF.	DESCRIPTION	No. OFF R.H.D.	No. OFF L.H.D.	REMARKS	
C.7672	2	3	Valve Guide : Inlet and Exhaust ..	8	8		
FST.5/14		4	Stud : Inlet and Exhaust Manifold (short)	4	4		
FST.5/22		5	Stud : Inlet and Exhaust Manifold (inter)	2	2		
FST.5/27		6	Stud : Inlet and Exhaust Manifold (long)	3	3		
C.10237		7	Stud : Top Cover .. .. .	4	4		
C.7708A		8	Plug : Induction Pipe, Rear .. ..	1	1		
C.7726A		9	Plug : Induction Pipe, Front .. ..	1	1		
CK.104/7			Countersunk Screw : Induction Pipe Plug .. .. .	2	2		
C.7699			Dowel : Cylinder Head to Manifold ..	1	1		
C.9831			Cylinder Head Water Jacket Plate ..	2	2		
C.7740			Cylinder Head Core Plug .. .. .	1	1		
<b>SIDE PLATE AND FITTINGS</b>							
300265			10	Side Plate : Cylinder Head .. .. .	1	1	
FS.104/4				Set Pin : Side Plate to Cylinder Head ..	6	6	
C.6541				Washer for Set Pin .. .. .	6	6	
C.7698		12	Sealing Washer : Side Plate .. .. .	1	1		
<b>VALVES AND SPRINGS.</b>							
C.7681		13	Inlet Valve .. .. .	4	4		
C.7682		14	Exhaust Valve .. .. .	4	4		
C.8644		15	Valve Spring (Inner) .. .. .	8	8		
C.8643		16	Valve Spring (Outer) .. .. .	8	8		
C.7771		17	Cup : Valve Spring .. .. .	8	8		
C.7715		18	Collar : Valve Spring .. .. .	8	8		
C.7738		19	Split Cotter : Valve Spring .. .. .	8 prs.	8 prs.		
<b>WATER OUTLET PIPE—DISTRIBUTION TUBE—CAMSHAFT.</b>							
C.8244		20	Water Outlet Pipe .. .. .	1	1		
C.8247		21	Washer : Water Outlet Pipe .. .. .	1	1		
FB.104/8		22	Bolt : Water Outlet Pipe .. .. .	4	4		
C.6541		23	Washer : Water Outlet Pipe .. .. .	4	4		
C.7772		24	Washer : Water Distribution Tube ..	1	1		
C.7742		25	Water Distribution Tube .. .. .	1	1		
C.7741		26	End Plate : Water Distribution Tube ..	1	1		
CK.104/7		27	Countersunk Screw : Water Distribu- tion Tube .. .. .	2	2		
<b>CAMSHAFT</b>							
C.11714		28	Camshaft <i>(superceded by C.12667)</i> ..	1	1		
C.7753		29	Chain Wheel : Camshaft .. .. .	1	1		
C.7719		29A	Drive Pins : Camshaft .. .. .	3	3		
C.6379			Bolt : Camshaft Chain Wheel .. .. .	1	1		
FS.106/6							

## ENGINE

PART No.	PLATE No.	PLATE REF.	DESCRIPTION	No. OFF		REMARKS
				R.H.D.	L.H.D.	
C.6396			Washer : Camshaft Chain Wheel ..	1	1	
C.6395			Lockwasher : Camshaft Chain Wheel	1	1	
<b>ROCKER BAR ASSEMBLY.</b>						
C.10286	2	30	Rocker Bar Assembly .. .. .	1	1	
C.7678			Bush : Valve Rockers .. .. .	8	8	
C.7611A		31	Valve Rocker Assembly .. .. .	8	8	
C.7729		32	Thrust Washer : Rocker .. .. .	4	4	
C.7730		33	Locating Spring : Valve Rocker ..	2	2	
C.6340		34	Adjusting Screw : Valve Rocker ..	8	8	
C.6427		35	Locknut : Valve Rocker Adjusting Screw	8	8	
FS.104/1		36	Screw : Locating Valve Rocker Bar ..	1	1	
No. 23			Woodruff Key : Cylinder Head ..	1	1	
C.9769			Locating Plate : Rocker Bar Screw ..	1	1	
C.7645B	1	95	Cylinder Head Gasket .. .. .	1	1	
N.107K		96	Fixing Nuts ; Cylinder Head .. ..	10	10	
W.107K			Washer : Cylinder Head Nuts.. ..	10	10	
<b>MANIFOLD AND BLEED PIPE.</b>						
300455 N.D.	2	37	Inlet and Exhaust Manifold, Studded ..	1	1	
FST.5/9		38	Studs : Exhaust Flange .. .. .	4	4	
FST.5/11		39	Studs : Carburettor .. .. .	2	2	
C.8251		40	Gasket : Inlet and Exhaust Manifold ..	1	1	
C.8252		41	Gasket : Exhaust Manifold .. .. .	2	2	
N.105K			Nuts : Inlet and Exhaust Manifold ..	9	9	
W.105K			Plain Washers : Inlet and Exhaust Manifold .. .. .	9	9	
C.7718		42	Induction Manifold Bleed Pipe ..	1	1	
C.6235		43	Screwed Bush : Induction Manifold Bleed Pipe .. .. .	1	1	
C.6236 N.D.		44	Compression sleeve: Induction Manifold	1	1	
C.5399			Clip : Bleed Pipe .. .. .	1	1	
R.H.103/8			Screw : Bleed Pipe Clip .. .. .	1	1	
N.100/K			Nut : Bleed Pipe Clip .. .. .			
<b>FRONT COVER—ROCKER COVER.</b>						
C.8356B		45	Front Cover : Cylinder Head .. ..	1	1	
C.8357B		46	Washer N/S : Front Cover .. .. .	1	1	
C.8358B		47	Washer O/S : Front Cover .. .. .	1	1	
FB.105/12		48	Bolt : Front Cover to Cylinder Head ..	4	4	
$\frac{5}{16}$ " Dia. Ext.		49	Washer (Shakeproof) .. .. .	4	4	
C.7807A		50	Rocker Cover Assembly .. .. .	1	1	
C.10240		51	Oil Filler Cap (Westwood) .. .. .	1	1	



## ENGINE

PART No.	PLATE No.	PLATE REF.	DESCRIPTION	NO. OFF		REMARKS
				R.H.D.	L.H.D.	
C.10242	2		Oil Filler Cap Sealing Ring .. ..	1	1	
C.7750		52	Joint Washer : Rocker Cover .. ..	1	1	
N.105K		53	Nut : Rocker Cover .. ..	4	4	
W.105K			Plain Washer : Rocker Cover Nut .. ..	6	6	
C.5407		54	Clip : Accelerator Cable .. ..	1	1	
C.10091			Sealing Washer : Top Cover Studs .. ..	4	4	
<b>WATER PUMP AND FAN.</b>						
C.9994 N.D.	1		Water Pump and Fan Complete Assy. . .	1	1	
C.10002 N.D.			Water Pump Body—Studded Assembly	1	1	
C.9926		97	Water Pump Body .. ..	1	1	
FST.4/6		98	Stud : Fan Bearing Housing .. ..	6	6	
FST.4/8		99	Stud : Water Inlet Pipe .. ..	2	2	
FST.6/6			Stud : Engine Mounting .. ..	2	2	
C.9679 N.D.			Fan Pulley and Blades Assembly .. ..	1	1	
C.9742		100	Fan Pulley .. ..	1	1	
FST.4/6		101	Stud : Fan Pulley .. ..	4	4	
C.9676A			Fan Blade Assembly .. ..	1	1	
C.9676		102	Fan Blades .. ..	2	2	
N.104K		103	Nut : Fan Blades .. ..	4	4	
$\frac{1}{4}$ " Dia. Ext.		104	Washer (Shakeproof) .. ..	4	4	
C.7579A		105	Bearing Housing : Fan .. ..	1	1	
C.8733		106	Seal : Fan Bearing Housing .. ..	1	1	
C.7701		107	Drive Shaft : Water Pump .. ..	1	1	
C.7580		108	Impeller : Water Pump .. ..	1	1	
N.206 B.R.			Nut : Impeller .. ..	1	1	
Hoffman LS.7		109	Ball Race : Water Pump Spindle .. ..	2	2	
C.7590		110	Spacing Collar : Water Pump .. ..	1	1	
C.7591		111	Seeger Circlip : Water Pump .. ..	1	1	
Tecalemit H1						
"B.S.F. Straight		112	Greaser : Fan Bearing Housing .. ..	1	1	
Woodruff No. 5		113	Key : Fan Pulley .. ..	1	1	
C.7655		114	Lock Washer .. ..	1	1	
C.10184		115	Nut : Water Pump Drive Shaft .. ..	1	1	
C.9227		116	Drain Tap : Water Pump Body .. ..	1	1	
C.7595		117	Washer : Inlet Pipe—Water Pump .. ..	1	1	
300261		118	Water Inlet Pipe .. ..	1	1	
N.104K			Nut : Water Pump .. ..	8	8	
$\frac{1}{4}$ " Dia. Ext.			Washer (Shakeproof) .. ..	2	2	
C.6541			Washer : Water Pump Bearing Housing	6	6	
C.8177		119	Washer : Water Pump Flange .. ..	1	1	
C.10074			Washer : Outlet Pipe—Water Pump .. ..	1	1	
C.7597			Washer : Rear of Water Pump .. ..	1	1	
N.106K			Nut : Water Pump to Cylinder Block	3	3	
$\frac{3}{8}$ " Dia. Ext.			Shakeproof Washer .. ..	3	3	
$\frac{5}{16}$ " Dia. Ext.			Washer (Shakeproof) .. ..	2	2	
C.9927		120	Fan Belt .. ..	1	1	

## ENGINE

PART No.	PLATE No.	PLATE REF.	DESCRIPTION	NO. OFF		REMARKS
				R.H.D.	L.H.D.	
C.9930	1		Retaining Stud : Water Pump Body and Dynamo .. .. .	1	1	
C.9931			Retaining Stud : Water Pump Body and Dynamo Adjusting Link .. ..	1	1	
<b>ACCESSORIES.</b>						
Lucas 22258	3		<b>Dynamo C.39PV2</b> .. .. .	1	1	
C.10010			Dynamo Pulley and Fan .. .. .	1	1	
C.9928			Dynamo Mounting Bracket (Rear End)	1	1	
FS.105/8			Set Pin : Dynamo Bracket to Engine Case .. .. .	2	2	
$\frac{5}{16}$ " Dia. Ext.			Shakeproof Washer .. .. .	2	2	
C.9929	1	122	Dynamo Link .. .. .	1	1	
N.105K		126	Nut : Dynamo Link to Pump Assembly	2	2	
$\frac{5}{16}$ " Dia. Ext.			Shakeproof Washer .. .. .	1	1	
FB.105/9			Bolt : Dynamo to Bracket .. .. .	1	1	
W.105K			Washer : Dynamo to Bracket .. ..	1	1	
$\frac{5}{16}$ " Dia. Ext.			Shakeproof Washer .. .. .	1	1	
N.105K			Nut : Dynamo to Bracket .. .. .	1	1	
W.107K			Dynamo Shaft Washer .. .. .	1	1	
Lucas 25022A	4		<b>Starter Motor M35G (4-Brush Type)</b>	1	1	
FB.106/8			Starter Motor Bolt .. .. .	2	2	
$\frac{3}{8}$ " Dia. Ext.			Shakeproof Washer .. .. .	2	2	
C.10026			Distance Piece : Dynamo Bracket ..	2	2	
Lucas 40167E	5		<b>Distributor Complete</b> .. .. .	1	1	
C.7749	1	128	Distributor Housing .. .. .	1	1	
FST.44/6		129	Stud : Distributor Housing .. ..	2	2	
N.104K		130	Nut : Distributor Housing .. .. .	4	4	
W.104K		131	Washer : Housing to Cylinder Block ..	2	2	
$\frac{1}{4}$ " Dia. Ext.			Shakeproof Washer .. .. .	2	2	
C.8757 N.D.			H.T. Cable Assembly .. .. .	4	4	
Champion N.8			Sparking Plugs .. .. .	4	4	
Lucas 45020A			<b>H. T. Coil Q12 Type LO</b> .. .. .	1	1	
FS.1041/4			H.T. Coil Support Bracket Set Pin ..	2	2	
N.104K			H.T. Coil Support Bracket Nut .. ..	2	2	
Solex 30 mm.						
FA1	6		<b>Carburettor</b> .. .. .	1	1	
N.105K			Carburettor Fixing Nut .. .. .	2	2	
$\frac{5}{16}$ " Dia. Ext.			Shakeproof Washer .. .. .	2	2	
C.9131			Carburettor Insulating Washer .. ..	1	1	
400618			<b>Air Silencer with Nuts and Washers</b> ..	1	1	
C.6222			Clip : Silencer to Adaptor .. .. .	1	1	
400385			Air Intake Adaptor .. .. .	1	1	

## ENGINE

PART No.	PLATE No.	PLATE REF.	DESCRIPTION	NO. OFF		REMARKS
				R.H.D.	L.H.D.	
FS.104/6			Air Intake Adaptor Set Pin .. ..	1	1	
N.104K			Air Intake Adaptor Nut .. ..	1	1	
400533			Air Silencer Steady Stay : Front ..	1	1	
400534			Air Silencer Steady Stay : Rear ..	1	1	
400396	1	132	<b>Oil Filter</b> Assembly Complete ..	1	1	
400519			Oil Filter Body .. ..	1	1	
400518			Oil Filter Element .. ..	1	1	
C.8835			Oil Filter Top Cover .. ..	1	1	
C.7723			Oil Filter Gasket .. ..	1	1	
FB.106/9			Bolt : Oil Filter .. ..	2	2	
C.10028			Locking Plate : Oil Filter Cover ..	1	1	
<b>CARBURETTOR PARTS.</b>						
C.9456 N.D.	6	2	Chamber, Throttle, machined casting only	1	1	
C.9457 N.D.		3	Spindle, Throttle .. ..	1	1	
C.9458 N.D.		4	Butterfly, Throttle .. ..	1	1	
C.9459 N.D.		5	Screw, Throttle, Butterfly Fixing ..	2	2	
C.9460 N.D.		6	Plate, Throttle, Slow Running Adjust- ment .. ..	1	1	
C.9461 N.D.		7	Screw, Throttle, Slow Running Adjust- ment .. ..	1	1	
C.9462 N.D.		8	Spring, Throttle, Slow Running Adjust- ment Screw .. ..	1	1	
C.9463 N.D.		9	Screw, Throttle, Stop .. ..	1	1	
C.9464 N.D.		10	Nut, Throttle Stop Screw .. ..	1	1	
C.9465 N.D.		11	Lever, Throttle .. ..	1	1	
C.9466 N.D.		12	Nut, Throttle, Spindle End .. ..	1	1	
C.9467 N.D.		13	Screw, Volume Control .. ..	1	1	
C.9468 N.D.		14	Spring, Volume Control Screw ..	1	1	
C.9469 N.D.		15	Washer, Flange .. ..	1	1	
C.9470 N.D.		16	Screw, Throttle Chamber Fixing ..	4	4	
C.9471 N.D.		17	Washer, Throttle Chamber Fixing Screw	4	4	
C.9472 N.D.		18	Gasket, Float Chamber to Throttle Chamber .. ..	1	1	
C.9473 N.D.		19	Body, Starter .. ..	1	1	
C.9474 N.D.		20	Valve, Starter, Complete .. ..	1	1	
C.9475 N.D.		21	Lever, Starter, Complete .. ..	1	1	
C.9476 N.D.		22	Bolt, Starter, Cable Fixing (in Starter Lever) .. ..	1	1	
C.9476 N.D.		23	Bolt, Starter, Cable Fixing (in Starter Support) .. ..	1	1	
C.9477 N.D.		24	Support Cable .. ..	1	1	
C.9478 N.D.		25	Screw, Cable Support, Fixing .. ..	2	2	
C.9479 N.D.		26	Ball, Starter Valve Locating .. ..	1	1	
C.9480 N.D.		27	Spring, Starter Valve Locating Ball ..	1	1	
C.9481 N.D.		28	Screw, Starter Body Fixing .. ..	4	4	
C.9482 N.D.		29	Jet G.A. Air .. ..	1	1	

## ENGINE

PART No.	PLATE No.	PLATE REF.	DESCRIPTION	No. OFF R.H.D.	No. OFF L.H.D.	REMARKS
C.9483 N.D.	6	30	Nut, Starter Spindle End .. ..	1	1	
C.9484 N.D.		31	Washer, Starter Spindle Distance .. ..	1	1	
C.9485 N.D.		32	Cover, Float Chamber .. ..	1	1	
C.9486 N.D.		33	Tube, Choke .. ..	1	1	
C.9487 N.D.		34	Screw, Choke Tube Fixing .. ..	1	1	
C.9488 N.D.		35	Valve, Needle .. ..	1	1	
C.9489 N.D.		36	Washer, Needle Valve .. ..	1	1	
C.9490 N.D.		37	Union .. ..	1	1	
C.9491 N.D.		38	Nut for Petrol Union .. ..	1	1	
C.9492 N.D.		39	Nipple for Petrol Union .. ..	1	1	
C.9493 N.D.		41	Washer, Banjo Union (Small) .. ..	1	1	
C.9494 N.D.		42	Chamber : Float, Bare .. ..	1	1	
C.9495 N.D.		43	Jet, Main .. ..	1	1	
C.9496 N.D.		44	Bleed, Main Jet Correction .. ..	1	1	
C.9497 N.D.		45	Tube, Main Jet Emulsion .. ..	1	1	
C.9498 N.D.		46	Jet, Auxiliary .. ..	1	1	
C.9499 N.D.		47	Bleed, Auxiliary, Jet Air .. ..	1	1	
C.9500 N.D.		48	Bolt, Main Jet Carrier .. ..	1	1	
C.9501 N.D.		49	Washer, Main Jet Carrier Bolt .. ..	1	1	
C.9502 N.D.		50	Plug, Float Chamber Drain .. ..	1	1	
C.9503 N.D.		51	Float .. ..	1	1	
C.9504 N.D.		52	Gasket, Float Chamber .. ..	1	1	
C.9505 N.D.		53	Screw, Float Chamber Assembly .. ..	1	1	
C.9506 N.D.		54	Washer, Float Chamber Assembly Screw .. ..	1	1	
C.9507 N.D.		55	Jet, G.S. Petrol .. ..	1	1	
C.9508 N.D.		56	Washer, Jet .. ..	1	1	
C.9501 N.D.		57	Washer, Float Chamber Drain Plug .. ..	1	1	
<b>SERVICEABLE PARTS FOR DISTRIBUTOR.</b>						
*415256	5	1	Plate Assembly .. ..			
*409563		2	Cover Assembly .. ..			
*404435		3	Brushes and Spring Assembly .. ..			
*400051		4	Rotor Arm Assembly .. ..			
*407050		5	Contact Set .. ..			
*409613		6	Condenser .. ..			
*406329		7	Cam Assembly .. ..			
*416042/S		8	Springs : Automatic Advance .. ..			
*400147		9	Weights : Automatic Advance .. ..			
*409582		10	Shaft and Action Plate .. ..			
*410590		11	Bearing, Bush, Top .. ..			
*404374		12	Bearing, Bush, Button .. ..			
*Lucas Accessories						

# ENGINE

PART No.	PLATE No.	PLATE REF.	DESCRIPTION	No. OFF R.H.D.	No. OFF L.H.D.	REMARKS	
<b>SERVICEABLE PARTS FOR STARTER MOTOR.</b>							
*250599	4	1	Shaft Cap .. .. .				
*251108		2	Brush Set .. .. .				
*251104		3	Bracket, Commutator End .. .. .				
<i>o.k.</i> *250626 (250426)		4	Bush, Commutator End .. .. .				
*251109		5	Brush Spring Set .. .. .				
*250404		6	Main Spring .. .. .				
*250698		7	Pinion and Barrel Assembly .. .. .				
*250691		8	Pinion Retaining Spring .. .. .				
*250412		9	Bracket, Drive End .. .. .				
*250678		10	Bush, Drive End .. .. .				
*250851		11	Armature .. .. .				
*251089		12	Field Coils .. .. .				
*249695			Sundry Parts Set .. .. .				
<b>SERVICEABLE PARTS FOR DYNAMO C39PV/2.</b>							
*227305 (227818)	3	1	Brush Set .. .. .				
*227702		2	Bracket, Commutator End .. .. .				
*227713		3	Bush Commutator End, Bearing .. .. .				
*238367		4	Oiler Assembly .. .. .				
*228159		5	Spring Set Brush Tension .. .. .				
*189307				Bearing, Driving End .. .. .			
*227698		6	Bracket Assembly : Driving End .. .. .				
*227693		8	Armature Assembly .. .. .				
*180740		7	Armature Shaft Nut .. .. .				
*227291		9	Field Coils .. .. .				
*104030				Through Bolt $\frac{1}{2}$ " B.S.F. .. .. .			
*227726				Sundry Parts Kit .. .. .			
*Lucas Accessories							

## CLUTCH

PART No.	PLATE No.	PLATE REF.	DESCRIPTION	No. OFF R.H.D.	No. OFF L.H.D.	REMARKS
<b>CLUTCH MAIN ASSEMBLY— HOUSING RELEASE BEARING.</b>						
C.8840 N.D.	7		Clutch Housing Assembly .. ..	1		
C.9156 N.D.			Clutch Housing Assembly .. ..		1	
C.8210B		12	Clutch Housing .. ..	1		
C.8210C			Clutch Housing .. ..		1	
C.2138		13	Clutch Fulcrum Bracket .. ..	1	1	
FB.105/6		14	Clutch Fulcrum Bracket Set Pin ..	2	2	
$\frac{5}{16}$ " Dia. Ext.			Shakeproof Washer .. ..	2	2	
C.2137		15	Clutch Withdrawal Lever .. ..	1	1	
C.2139			Clutch Withdrawal Lever Pin .. ..	1	1	
FST.6/13			Gearbox and Clutch Housing Stud ..	6	6	
C.9451 N.D.		10	Clutch Release Bearing and Cup Assy. .	1	1	
C.9452 N.D.		11	Clutch Release Bearing Retainer ..	2	2	
C.10508 N.D.			Clutch Main Assembly .. ..	1	1	
C.6194		1	Clutch Spigot Bearing .. ..	1	1	
FS.105/5			Clutch Fixing Set Pins .. ..	6	6	
$\frac{5}{16}$ " Dia. Ext.			Shakeproof Washers .. ..	6	6	
C.10252A		16	Clutch Housing Cover .. ..	1	1	
FS.104/4			Cover to Housing Set Pin .. ..	3	3	
$\frac{1}{4}$ " Dia. Ext.			Shakeproof Washer .. ..	3	3	
FB.105/10			Gearbox Clutch Assembly to Case Bolt	5	5	
FB.105/12			Gearbox Clutch Assembly to Case Bolt	3	3	
FB.105/16			Gearbox Clutch Assembly to Case Bolt	2	2	
W.105K			Gearbox Clutch Assembly to Case Washer	2	2	
$\frac{5}{16}$ " Dia. Ext.			Shakeproof Washer .. ..	8	8	
N.106K			Clutch Housing to Gearbox Unit Nut	6	6	
$\frac{3}{8}$ " Dia. Ext.			Shakeproof Washer .. ..	6	6	
C.6141			Clutch Housing to Gearbox Washer ..	1	1	
C.10511 N.D.		1A	Clutch Driven Plate (B & B45962/24) ..	1	1	
C.9454 N.D.			Clutch Facing Package (2 Facings 42415 and 22 Rivets 44055) .. ..			
C.9440 N.D.		2	Cover .. ..	1	1	
C.9441 N.D.		4	Thrust Springs (Cream) .. ..	6		
C.9442 N.D.		3	Pressure Plate .. ..	1		
C.9443 N.D.		7A	Eye Bolt .. ..	3		
C.9444 N.D.		8	Nut : Eye Bolt .. ..	3		
C.9445 N.D.		6	Release Lever .. ..	3		
C.9446 N.D.		7C	Pin : Release Lever .. ..	3		
C.9447 N.D.		7B	Strut .. ..	3		
C.9448 N.D.		5	Release Lever Plate .. ..	1		
C.9449 N.D.		7	Retainer : Release Lever Plate .. ..	3		
C.9450 N.D.		9	Springs : Anti-Rattle .. ..	3		

## GEARBOX

PART No.	PLATE No.	PLATE REF.	DESCRIPTION	NO. OFF R.H.D.	NO. OFF L.H.D.	REMARKS
<b>GEARBOX.</b>						
400563 N.D.			Clutch Housing & Gearbox Assembly ..	1		
400564			Clutch Housing & Gearbox Assembly ..		1	
400615	7	19	Gearbox Casing : Studded .. ..	1		
400382			Gearbox Casing : Studded .. ..		1	
C.2625		19A	Clutch Pedal Shaft .. ..	1		
No. 3 × 1½"			Taper Pin .. ..	1		
FST.5/9		20	Gearbox to End Cover Stud .. ..	7	7	
FST.5/9		21	Gearbox to Top Cover Stud .. ..	6	6	
C.6372		22	Drain Plug .. ..	1	1	
C.6303		23	Drain Plug Washer .. ..	1	1	
C.6347		23A	Gearbox to Top Cover Dowel .. ..	2	2	
<b>LAYSHAFT ASSEMBLY.</b>						
400536	7		Layshaft Gear Assembly .. ..	1	1	
C.6149		24	1st Speed Layshaft Gear .. ..	1	1	
C.6150		25	2nd Speed Layshaft Gear .. ..	1	1	
C.7006		26	3rd Speed Layshaft Gear .. ..	1	1	
400527		27	4th Speed Layshaft Gear .. ..	1	1	
C.6188		27A	Layshaft Gear Spring Ring .. ..	1	1	
C.6186		28	Layshaft Gear Thrust Washer, 2¼" dia. by .53" .. ..	1	1	
C.6763		29	Layshaft Bush .. ..	2	2	
C.6088		30	Layshaft .. ..			
C.7397A		31	Thrust Washer Assembly, 2¼" o/d. × 140"			} 1 per set as Required
C.7398A		31	Thrust Washer Assembly, 2¼" o/d. × 144"			
C.7399A		31	Thrust Washer Assembly, 2¼" o/d. × 149"			
C.6122A		31A	Thrust Washer Assembly, 1¾" o/d. 5.39" i/d			
C.7396			Thrust Washer, 1½" o/d. 5.39" i/d ..			
<b>REVERSE GEAR— REVERSE SELECTOR FORK.</b>						
C.10158	7	32	Reverse Gear Assembly .. ..	1	1	
C.10157			Reverse Gear .. ..	1	1	
C.10159			Reverse Gear Bush .. ..	2	2	
C.6119		33	Reverse Gear Shaft .. ..	1	1	
C.6196		34	Reverse Gear Retaining Plate .. ..	1	1	
C.6123		35	Reverse Gear Retaining Pin .. ..	1	1	
C.6092		36	Reverse Selector Fork .. ..	1	1	
C.6112A		37	Reverse Selector Retainer Plate Assembly	1	1	
W205K		38	Reverse Selector Retainer Guide Pin Washer .. ..	2	2	
N.405K		39	Reverse Selector Retainer Guide Pin Nut	2	2	
SP.206			Reverse Selector Retainer Guide Pin Split Pin .. ..	2	2	

## GEARBOX

PART No.	PLATE No.	PLATE REF.	DESCRIPTION	No. OFF R.H.D.	No. OFF L.H.D.	REMARKS
<b>MAINSHAFT AND GEARS.</b>						
400736	7	40	Mainshaft .. .. .	1	1	
C.6095		41	Mainshaft Thrust Washer .. ..	3	3	
C.6094		42	Mainshaft Gear Bush .. .. .	1	1	
C.6081		43	2nd Speed Mainshaft Gear .. ..	1	1	
C.7018		44	3rd Speed Mainshaft Gear Assembly ..	1	1	
C.9059			3rd Speed Mainshaft Gear Bush ..	1	1	
C.9058			Key : Thrust Washer .. .. .	1	1	
C.7027		45	3rd and 4th Speed Synchro Sleeve Assy.	1	1	
C.2288			3rd and 4th Speed Synchro Sleeve Spring	6	6	
C.6954 N.D.			3rd and 4th Speed Synchro Sleeve Ball	6	6	
C.9086		46	3rd and 4th Speed Synchro Sleeve Dog	1	1	
C.7250		47	2nd Speed Synchro Sleeve Assembly ..	1	1	Up to Gearbox No. 4AD 322U
C.10335			2nd Speed Synchro Sleeve Assembly ..	1	1	From Gearbox No. 4AD 323U
C.6663		48	1st Speed Gear Stop .. .. .	1	1	Up to Gearbox No. 4AD 322U
C.10336			1st Speed Gear Stop .. .. .	1	1	From Gearbox No. 4AD 323U
C.9022			Seeger Circlip for Mainshaft .. ..	1	1	
C.6990		49	2nd Speed Synchro Spring .. .. .	6	6	
$\frac{5}{16}$ " Dia. C.10333		50	2nd Speed Synchro Ball .. .. .	6	6	
C.6954			Locking Pin 2nd Speed Synchro Sleeve	1	1	} From Gearbox No. 4AD 323U
400630			Locking Ball 2nd Speed Synchro Sleeve	1	1	
		51	1st Speed Mainshaft Gear .. .. .	1	1	Up to Gearbox No. 4AD 322U
400737			1st Speed Mainshaft Gear .. .. .	1	1	From Gearbox No. 4AD 323U
C.6760		52	Rear Bearing .. .. .	1	1	
C6530		53	" " Spring Ring .. .. .	1	1	
<b>CONSTANT MESH PINION.</b>						
400535		54	Constant Mesh Pinion Assembly ..	1	1	
C.6115		55	Constant Mesh Bearing .. .. .	1	1	
C.6116		56	Constant Mesh Bearing Spring Ring ..	1	1	
C.6125		57	Constant Mesh Bearing Lockwasher ..	1	1	
C.6124		58	Constant Mesh Bearing Locknut .. ..	1	1	
C.6143		59	Constant Mesh Bearing Bush .. .. .	1	1	
<b>REAR END COVER AND SPEEDO. GEARS.</b>						
C.6128		60	Speedo. Gears .. .. .	1	1	
C.6140		61	End Cover Joint Washer .. .. .	1	1	



## GEARBOX

PART No.	PLATE No.	PLATE REF.	DESCRIPTION	No. OFF		REMARKS
				R.H.D.	L.H.D.	
400371	7	62	Rear End Cover .. .. .	1	1	Comprises 400371 and 400553
C7051		63	Oil Seal : Rear End Cover .. .. .	1	1	
400552			Thrust Button : Speedo. Pinion .. .. .	1	1	
400553			Bush : Speedo. Pinion .. .. .	2	2	
N.105K		66	End Cover to Gearbox Nut .. .. .	7	7	
W.105K			End Cover to Gearbox Washer .. .. .	7	7	
C.9075		68	Speedo. Pinion .. .. .	1	1	
C.6848		64	Universal Joint Flange .. .. .	1	1	
C.7017		65	Universal Joint Flange Nut .. .. .	1	1	
SP.412			Universal Joint Flange Split Pin .. .. .	1	1	
FB.105/7F		70	Propellor Shaft Bolt .. .. .	4	4	
N.105K			Propellor Shaft Nut .. .. .	4	4	
C.6304			Propellor Shaft Lockwasher .. .. .	4	4	
400589			Rear End Cover Speedo Gear Assembly	1	1	
400565			Rear End Cover with Bushes .. .. .	1	1	
C.9664		71	Dipstick Assembly .. .. .	1	1	
C.6962			Dipstick Cork .. .. .	1	1	
<b>GEARBOX TOP COVER.</b>						
C.9362	8		Gearbox Top Cover Complete Assembly with Striker Gear, Remote Control and Change Speed Lever, etc. .. .. .	1	1	} Assembly C.8173
			Gearbox Top Cover Sub-Assembly .. .. .	1	1	
C.8173			Gearbox Top Cover .. .. .	1	1	
C.6075		72	Gearbox Top Cover Cap .. .. .	1	1	
C.6076		73	Stud : Selector Fork Housing .. .. .	4	4	
C.6096		73A	Stud : Top Cover to Cap .. .. .	2	2	
FST.5/11		73B	Nut : Top Cover to Cap .. .. .	6	6	
N.105K		73C	Washer : Top Cover to Cap .. .. .	6	6	
W.105K			Bolt : 4th Speed Selector Stop .. .. .	1	1	
C.7411		83	Locknut : 4th Speed Selector Stop .. .. .	1	1	
N.206K		83A	Washer : 4th Speed Selector Stop .. .. .	1	1	
W.106K			Gear Locating Body Adjuster .. .. .	1	1	
C.6130		84	Nut : Gear Locating Body Adjuster .. .. .	1	1	
N.105K			Ferrule : Reverse Stop .. .. .	1	1	
C.6097		85	Spring : Reverse Stop .. .. .	1	1	
C.6120		86	Retaining Plate : Reverse Stop .. .. .	1	1	
C.6129		87	Screw : Retaining Plate, Reverse Stop .. .. .	2	2	
2BA/B3		88	Shakeproof Washer .. .. .	2	2	
$\frac{3}{16}$ " Dia. Ext.		89	Reverse Lever .. .. .	1	1	
C.6836		90	Reverse Lever : Fulcrum Pin .. .. .	1	1	
C.6114	91					
<b>STRIKER GEAR.</b>						
C.7299		92	1st/2nd and 3rd/4th Striker Fork .. .. .	2	2	
C.6093A		93	Reverse Striker Bar .. .. .	1	1	
C.6087		94	Selector Fork Housing .. .. .	1	1	

## GEARBOX

PART No.	PLATE No.	PLATE REF.	DESCRIPTION	No. OFF		REMARKS	
				R.H.D.	L.H.D.		
C.6104	8	95	Selector Fork Plunger .. .. .	3	3		
C.7387		97	Selector Plunger Sealing Washer .. .. .	3	3		
C.6105		96	Selector Fork Plunger Spring .. .. .	3	3		
C.6837		98	Reverse Link .. .. .	1	1		
C.6113		98A		Reverse Link Lever Pin .. .. .	1	1	
W.106K				Reverse Link Lever Pin Washer .. .. .	2	2	
SP.206				Reverse Link Lever Pin Split Pin .. .. .	2	2	
C.6870		98B		Selector Housing Tabwasher .. .. .	4	4	
N.105K		98C		Selector Housing Nut .. .. .	4	4	
<b>REMOTE CONTROL.</b>							
C.8171			Remote Control End Housing Sub-Assy.	1	1		
C.6060		74	Remote Control End Housing .. .. .	1	1		
C.6133		75	Remote Control Tube .. .. .	1	1		
FST.4 10		75C	Remote Control End Housing Stud .. .. .	3	3		
$\frac{3}{16}$ " Dia. C'sk. $\times \frac{1}{2}$ "			75D	Rivet .. .. .	2	2	
FB.105/16		75A	Bolt : End Housing .. .. .	1	1		
N.105K		75B	Nut : End Housing .. .. .	1	1		
W.105K				Washer : End Housing .. .. .	1	1	
C.6121A			End Housing Rear End Bush .. .. .	1	1		
C.6098		76	Gear Locating Body .. .. .	1	1		
C.6099A		77	Remote Control Front End Bush .. .. .	1	1		
C.6101A		78	Remote Control Actuating Shaft .. .. .	1	1		
C.6100B		79	Actuating Shaft Lever End Assembly .. .. .	1	1		
C.7026				Actuating Shaft Bush .. .. .	1	1	
N.106K		80	Actuating Shaft Lever End Nut .. .. .	1	1		
W.106K		81	Actuating Shaft Lever End Washer .. .. .	1	1		
C.6347				Remote Control to Top Cover Dowel .. .. .	1	1	
<b>CHANGE SPEED LEVER AND TOP COVER FIXINGS.</b>							
C.9315A		99	Change Speed Lever Assembly .. .. .	1	1		
C.6998		100	Change Speed Lever Cap .. .. .	1	1		
Simmonds $\frac{1}{4}$ " B.S.F.				Change Speed Lever Cap Nut .. .. .	3	3	
C.2631		101	Change Speed Lever Knob .. .. .	1	1		
C.6139	7	102	Top Cover to Gearbox Joint Washer .. .. .	1	1		
N.105K	8	102B	Top Cover to Gearbox Nut .. .. .	6	6		
W.105K		102A	Top Cover to Gearbox Washer .. .. .	6	6		
<b>CLUTCH PEDAL.</b>							
400116	7	103	Clutch Pedal Assembly .. .. .	1			
N.107K		105	Clutch Pedal Rod Eye Nut .. .. .	2			
C.5669A		104	Clutch Pedal Pad and Rod Assembly .. .. .	1			
C.6723		106	Clutch Pedal Tread Rubber .. .. .	1			

## GEARBOX

PART No.	PLATE No.	PLATE REF.	DESCRIPTION	NO. OFF R.H.D.	NO. OFF L.H.D.	REMARKS	
FS.105/10	7	107	Clutch Pedal Stop Bolt .. ..	1			
N.105K		108	Clutch Pedal Stop Bolt Nut .. ..	1			
Tecalemit H1				Grease Nipple .. ..	1		
C.6445		110	Clutch Pedal Retaining Washer ..	1			
400129		111	Clutch Pedal Coupling Rod Assembly ..	1			
C.6349		112	Clutch Pedal Rod Swivel Pin Spring ..	1			
C.6403		113	Clutch Pedal Rod Swivel Spherical Nut	1			
N.205K		114	Clutch Pedal Coupling Rod Locknut ..	3			
W.105K				Clutch Pedal Coupling Rod Washer ..	1		
C.6312				Clutch Pedal Return Spring .. ..	1	1	
W.206K			Clutch Pedal Coupling Rod Washer ..	1			

## ENGINE MOUNTNG

PART No.	PLATE No.	PLATE REF.	DESCRIPTION	NO. OFF R.H.D.	NO. OFF L.H.D.	REMARKS
<b>ENGINE MOUNTING.</b>						
400357	12	87	Engine Mounting Cross Member Assy.	1	1	
FS.106/5			Engine Mounting Cross Member Set Pin	2	2	
C.8166A		88	Front Engine Mounting Rubber ..	1	1	
N.206K			Front Engine Mounting Rubber Nut ..	4	4	
$\frac{3}{8}$ " Dia. Ext.			Shakeproof Washer .. .. .	4	4	
C.8881		89*	Rear Mounting Rubber .. .. .	2	2	
FB.106/14			Rear Mounting Rubber Bolt .. ..	2	2	
$\frac{3}{8}$ " B.S.F.						
GKN JA1			Rear Mounting Rubber Nut .. ..	2	2	
FS.105/6			Set Pin : Mounting Rubber to Frame ..	4	4	
$\frac{5}{16}$ " B.S.F.						
GKN1			Nut : Mounting Rubber to Frame ..	4	4	
W.105K			Washer : Mounting Rubber to Frame ..	4	4	
FS.106/5			Engine Mounting Cross Member to Frame Set Pin .. .. .	4	4	
400361		90	Torque Arm Assembly .. .. .	1	1	
C.9073		91	Torque Arm Reaction Buffer .. ..	2	2	
N.104K			Torque Arm Reaction Buffer Nut ..	1	1	
N.204K			Torque Arm Reaction Buffer Locknut ..	1	1	
$\frac{1}{4}$ " Dia. Ext.			Shakeproof Washer .. .. .	2	2	
400360		92	Adjustment Plate Assembly .. ..	1	1	
N.105K			Nut : Adjustment Plate to Frame ..	2	2	
W.105K			Washer : Adjustment Plate to Frame ..	2	2	

\* metalastik # 17/223

## INDEPENDENT SUSPENSION

PART No.	PLATE No.	PLATE REF.	DESCRIPTION	No. OFF R.H.D.	No. OFF L.H.D.	REMARKS
<b>INDEPENDENT SUSPENSION. BOTTOM WISHBONE ASSEMBLY.</b>						
300144	9	1	Bottom Wishbone Rear Half Assembly ..	2	2	
C.9029		2	Bottom Wishbone Rear Half Bush ..	2	2	
300142		3	Bottom Wishbone Front Half Assembly	2	2	
300293		4	Tabwasher : Front Half to Rear Half ..	2	2	
FS.106/6F		5	Set Pin : Front Half to Rear Half ..	4	4	
C.5695		5	Pivot Bushing .. .. .	8	8	
Tecalemit HA39			Greaser : Bottom Wishbone .. ..	2	2	
<b>OUTER SUPPORT BRACKET ASSEMBLY.</b>						
300162		6	Outer Support Bracket : Bottom Wish- bone Pivot .. .. .	4	4	
300448		7	Pivot Stop : Outer Support Brkt. Front	2	2	
300449		8	Pivot Stop : Outer Support Brkt. Rear	2	2	
300167		9	Bottom Arm Pivot Pin .. .. .	2	2	
300450			Bottom Arm Pivot Pin Washer .. ..	2	2	
$\frac{7}{16}$ " B.S.F. GKN. LA1			Bottom Arm Pivot Pin Nut .. ..	2	2	
<b>TOP ARM ASSEMBLY.</b>						
300146		10	Top Arm and Bush Assembly .. ..	4	4	
C.9030		11	Top Arm Bush .. .. .	4	4	
C.9434A		12	Top Arm Trunnion Assembly .. ..	2	2	
300171		13	Top Arm Connecting Pin .. .. .	2	2	
400548		14	Top Arm Connecting Pin Shim .. ..	as required		
C.7893		15	Top Arm Thrust Washer .. .. .	4	4	
C.7966		16	Grease Retaining Washer .. .. .	4	4	
C.8013		17	Dust Cap .. .. .	4	4	
N.206K		18	Nut .. .. .	4	4	
Tecalemit NA.5799		12A	Greaser .. .. .	2	2	
FB.106/12D			Bolt : Top Arm Assy. to Top Bracket..	6	6	
$\frac{3}{8}$ " Dia. Ext.			Shakeproof Washer .. .. .	6	6	
300335		19	Top Arm Adjusting Shim .. .. .	as required		
<b>TOP ARM SWIVEL PINS— SWIVEL PIN.</b>						
300166		20	Top Arm Pivot Pin .. .. .	2	2	
C.5695		21	Top Arm Pivot Pin Bush .. .. .	8	8	
300264		22	Top Arm Bushing Support Washer ..	4	4	

## INDEPENDENT SUSPENSION

PART No.	PLATE No.	PLATE REF.	DESCRIPTION	No. OFF		REMARKS	
				R.H.D.	L.H.D.		
N.407K	9	23	Top Arm Bushing Support Nut ..	4	4		
300197		24	Swivel Pin, L.H. .. ..	1	1		
300198			Swivel Pin, R.H. .. ..	1	1		
C.8015		25	Bottom Arm Swivel Pin .. ..	2	2		
C.7894		26	Top Arm Thrust Washer .. ..	4	4		
$\frac{7}{16}$ " B.S.F. GKN. PA1		25A	Nut : Bottom Arm Swivel Pin .. ..	2	2		
C.8531		27	Oil Retaining Ring : Swivel Pin .. ..	4	4		
W.110K		28	Washer : Swivel Pin .. ..	2	2		
C.3814		29	Nut : Swivel Pin .. ..	2	2		
C.7894		30	Thrust Washer : Swivel Pin .. ..	2	2		
C.7965		30A	Grease Retaining Washer .. ..	4	4		
FST.4/6			Stud : Bottom Wishbone Outer Support Bracket to I.F.S. Crossmember .. ..	12	12		
$\frac{1}{4}$ " Dia. Ext. G.104K			Shakeproof Washer .. ..	12	12		
			Nut .. ..	12	12		
<b>SWIVEL LEVERS.</b>							
300152			31	Axle Swivel Lever, R.H. .. ..	1	1	
300153				Axle Swivel Lever, L.H. .. ..	1	1	
Woodruff No. 9			Axle Swivel Key .. ..	2	2		
C.6447			Axle Swivel Washer .. ..	2	2		
C6433			Axle Swivel Nut .. ..	2	2		
<b>SPRING BOTTOM CARRIER.</b>							
400288		32	Spring Bottom Carrier Assembly : R.H.	1	1		
400289			Spring Bottom Carrier Assembly : L.H.	1	1		
N.107K			Spring Bottom Carrier Nut .. ..	4	4		
400374			Packing Piece .. ..	2	2		
<b>COIL SPRING TOP BRACKET— TOP ARM SUPPORT BRACKET— COIL SPRING.</b>							
400330		33	Coil Spring Top Bracket Assembly .. ..	2	2		
FB.105/6			Bolt : Coil Spring Top Bracket .. ..	8	8		
N.107K			Nut : Coil Spring Top Bracket .. ..	4	4		
300039		34	Coil Spring Insulation Rubber .. ..	4	4		
400567		35	Coil Spring .. ..	2	2		
FB.107/33D			Bolt : Suspension to Frame (Long) .. ..	8	8		
FB.107/6			Bolt : Suspension to Frame (Short) .. ..	2	2		
400454			Locking Plate .. ..	4	4		
$\frac{7}{16}$ " Dia. Ext.			Shakeproof Washer .. ..	2	2		

## INDEPENDENT SUSPENSION

PART No.	PLATE No.	PLATE REF.	DESCRIPTION	NO. OFF R.H.D.	NO. OFF L.H.D.	REMARKS
<b>AXLE SWIVEL—HUB—DRUM.</b>						
300316	9	36	Axle Swivel Assembly : R.H. .. ..	1	1	} Complete with Bridge Pipe Assy. H.2990A and Hose Assembly H.3271H
300315			Axle Swivel Assembly : L.H. .. ..	1	1	
C.9029		37	Axle Swivel Bush .. ..	4	4	
Tecalemit HA39			Greaser .. ..	2	2	
300344		38	Front Back Plate Assembly : R.H. .. ..	1	1	
300345			Front Back Plate Assembly : L.H. .. ..	1	1	
FS.106/6		39	Front Back Plate Set Pin .. ..	8	8	
N.106K			Front Back Plate Nut .. ..	8	8	
$\frac{3}{8}$ " Dia. Ext.			Shakeproof Washer .. ..	8	8	
300438		40	Front Hub Assembly .. ..	2	2	
C.7975		41	Wheel Stud .. ..	8	8	
C.7976		42	Wheel Stud Nut .. ..	8	8	
300396		43	Front Hub Distance Piece : Inner Brg.	2	2	
C.7891		44	Oil Retaining Rings .. ..	2	2	
C.7881		45	Oil Retaining Washer .. ..	2	2	
Hoff. MS10		46	Inner Bearing .. ..	2	2	
Hoff. MS8		47	Outer Bearing .. ..	2	2	
300397		48	Bearing Spacer .. ..	2	2	
300434		49	Nut : Axle Swivel .. ..	2	2	
30044		50	Brake Drum .. ..	2	2	
CK.104/7		51	Screw : Brake Drum to Hub .. ..	4	4	
300436		52	Hub Cover Assembly .. ..	2	2	
<b>FRONT STABILISER BAR AND FIXINGS.</b>						
400196		53	Front Stabiliser Bar .. ..	1	1	
400345		54	Bearing Rubber .. ..	2	2	
C.8979		54A	Bearing Rubber Stirrup .. ..	2	2	
FS.106/5			Bearing Rubber Stirrup Set Pin .. ..	4	4	
$\frac{3}{8}$ " Dia. Ext.			Shakeproof Washer .. ..	4	4	
C.8497		55	Link .. ..	2	2	
N.106K			Nut for Link .. ..	4	4	
$\frac{3}{8}$ " Dia. Ext.			Shakeproof Washer .. ..	4	4	
<b>FRONT SHOCK ABSORBERS AND FIXINGS.</b>						
400146		56	Front Shock Absorber .. ..	2	2	
400140		57	Front Shock Absorber Pivot Bush .. ..	4	4	Armstrong AT.7/344
400421		58	Top Mounting Rubber .. ..	4	4	Armstrong AT.7/345

## INDEPENDENT SUSPENSION

PART No.	PLATE No.	PLATE REF.	DESCRIPTION	No. OFF		REMARKS	
				R.H.D.	L.H.D.		
400422	9	59	Top Mounting Rubber Retaining Washer	4	4	Armstrong AT.7/368	
400423		60	Top Mounting Rubber Spacing Tube ..	2	2		Armstrong AT.7/369
N.106K				Fixing Nut : Top Spacing Tube ..	2	2	
N.206K				Locknut : Top Spacing Tube ..	2	2	
C.9786		61		Shock Absorber Bottom Bracket and Bolt	2	2	
C.9784		62		Shock Absorber Bottom Bracket	2	2	
FB.107/17		63		Pivot Bolt .. .. .	2	2	
$\frac{7}{16}$ " B.S.F. GKN. LB1				Nut : Pivot Bolt .. .. .	2	2	
C.9785		64		Tube for Bottom Bracket Rubber ..	2	2	
$\frac{1}{2}$ " B.S.F. GKN. NB1				Nut for Bottom Bracket .. .. .	2	2	
400332		65		Anchor Bracket .. .. .	2	2	
N.105K				Anchor Bracket Nut .. .. .	8	8	
$\frac{5}{16}$ " Dia. Ext.				Shakeproof Washer .. .. .	8	8	
<b>FRONT BRAKE BACK PLATE. EXPORT SERVICE ONLY.</b>							
Girling Nos.							
GB.40446			Front Back Plate : L.H. .. .. .	2	2		
GB.40447			Front Back Plate : R.H. .. .. .	2	2		
GB.40612			Snail Cam .. .. .	2	2		
GB.40458			Snail Cam Bush .. .. .	2	2		
GB.40039			Snail Cam Spindle .. .. .	2	2		
GB.39755			Snail Cam Spring .. .. .	2	2		
<b>STEERING. FRONT CROSS TUBE (STEERING FIXING).</b>							
400032	10	1	Front Cross Tube Assembly .. .. .	1	1		
400039		2	Front Cross Tube Fixing Bolt .. .. .	2	2		
$\frac{5}{8}$ " int. dia.		3	Shakeproof washer : Fixing Bolt .. .. .	2	2		
400036		4	Packing Washer (8G) .. .. .			} 1 off as required	
400037			Packing Washer (9G) .. .. .				
400038		Packing Washer (10G) .. .. .					



## STEERING

PART No.	PLATE No.	PLATE REF.	DESCRIPTION	No. OFF		REMARKS
				R.H.D.	L.H.D.	
<b>STEERING COLUMN.</b>						
400545	10		Steering Column Assembly .. ..	1		
400546			Steering Column Assembly .. ..		1	
400085		5	Steering Drop Arm .. ..	1		
400084			Steering Drop Arm .. ..		1	
300112		6	Steering Wheel .. ..	1	1	
400026		7	Column Support Bottom Bracket ..	1		
400420			Column Support Bottom .. ..		1	
FB.105/12			Column Support Bolt .. ..	1	1	
$\frac{5}{16}$ " Dia. Ext.			Shakeproof Washer .. ..	1	1	
400543		8	Steering Wheel Washer .. ..	1	1	
400542		9	Bridge Piece Assembly .. ..	1	1	
400540		10	Cap : Steering Wheel .. ..	1	1	
400539			Cap Assembly : Fixing Stud .. ..	1	1	
400273		11	Dash Steering Support Bracket ..	1	1	
400274		12	Dash Steering Support Bracket Washer Plate .. ..	1	1	
FB.105/8		12A	Bolt : Steering Support Bracket ..	4	4	
C.3291		13	Bracket : Steering Column .. ..	2	2	
FB.105/17		13A	Bracket : Steering Column Bolt (Long)	1	1	
FB.105/15		13B	Bracket : Steering Column Bolt (Short)	1	1	
N.105K			Nut .. ..	6	6	
$\frac{5}{16}$ " Dia. Ext.			Shakeproof Washer .. ..	6	6	
<b>SERVICEABLE PARTS FOR STEERING COLUMN AND BOX.</b>						
SI-36		14	Outer Column and Box Assembly ..	1		
SI-37			Outer Column and Box Assembly ..		1	
SI1-14		15	End Plate .. ..	1	1	
S3-53		16	Inner Column .. ..	1		
S3-54			Inner Column .. ..		1	
11-7-4		16A	Inner Column Nut .. ..	1	1	
12-9-6			Ballrace Packing Washer .. ..	1	1	
17-1-1		17	Steel Balls .. ..	Set	28	
S7-18		18	Rockershaft .. ..	1	1	
S-19-2		19	Rockershaft Ball Peg .. ..	1	1	
31-6-1		20	Rockershaft Ball Peg Circlip .. ..	1	1	
17-4-1		21	Rockershaft Steel Balls .. ..	Set	8	
11-8-5		22	Rockershaft Nut .. ..	1	1	
12-8-22		23	Rockershaft Spring Washer .. ..	1	1	
27-8-12		24	Rockershaft Oil Seal .. ..	1	1	
12-8-20		25	Rockershaft Oil Seal Washer .. ..	1	1	
25-8-1		26	Rockershaft Adjusting Screw .. ..	1	1	
11-8-3		27	Rockershaft Adjusting Screw Locknut	1	1	
S10-10		28	End Plate Washer (Paper) .. ..			} To suit Assembly
S.10-12		29	End Plate Washer (Steel) .. ..			

## STEERING

PART No.	PLATE No.	PLATE REF.	DESCRIPTION	NO. OFF R.H.D.	NO. OFF L.H.D.	REMARKS
S.12-15	10	30	Cover Plate .. .. .	1		
S.12-16			Cover Plate .. .. .		1	
10-3-5		31	Cover Plate Bolt .. .. .	4	4	
12-3-2			Cover Plate Spring Washer .. .. .	7	7	
10-3-6		32	End Plate Bolt .. .. .	3	3	
S.23-4		33	Adjustable Ball Race .. .. .	2	2	
21-7-2		34	Oil Plug .. .. .	1	1	
12-7-1		35	Oil Plug Washer .. .. .	1	1	
19-8-17		36	Inner Column Bush (Plain) .. .. .	1	1	
12-8-21			Inner Column Bush Washer .. .. .	1	1	
12-6-1		37	Ball Peg Plain Washer .. .. .	1	1	
12-6-2		38	Ball Peg Spring Washer .. .. .	1	1	
12-8-18		39	Rockershaft Dished Washer .. .. .	1	1	
31-12-3		40	Rockershaft Dished Washer Circlip .. .. .	1	1	
<b>IDLER LEVER AND FIXINGS— TIE RODS.</b>						
400021		41	Idler Lever Bearing Assembly .. .. .	1		
400022			Idler Lever Bearing Assembly .. .. .		1	
C.9030		42	Bush .. .. .	2	2	
Tecalemit HA44			Greaser .. .. .	1	1	
FS.105/6			Set Pin—Idler Lever Bearing Assembly to Frame .. .. .	2	2	
$\frac{5}{16}$ " Dia. Ext.			Shakeproof Washer .. .. .	2	2	
W.205K			Packing Washer .. .. .	2	2	
300211		43	Idler Lever Spindle .. .. .	1	1	
C.7893		44	Thrust Washer .. .. .	2	2	
C.7966		45	Grease Retaining Ring .. .. .	2	2	
300212		46	Retaining Washer .. .. .	1	1	
$\frac{3}{8}$ " B.S.F.						
GKN. JA.1		47	Nut : Idler Lever Spindle .. .. .	1	1	
300200		48	Idler Lever .. .. .	1		
300199			Idler Lever .. .. .		1	
W.109K			Washer .. .. .	1	1	
$\frac{9}{16}$ " B.S.F.						
GKN. PA.1		49	Nut .. .. .	1	1	
300195		50	Tie Rod : Outer .. .. .	2	2	
300196		51	Tie Rod : Centre .. .. .	1	1	
Tecalemit HA20			Greaser .. .. .	6	6	
<b>TIE ROD SERVICEABLE PARTS.</b>						
J.4670		52	Socket Assembly (R.H. Thread) Outer Rod .. .. .	2	2	
J.4671		53	Socket Assembly (L.H. Thread) Outer Rod .. .. .	2	2	

## STEERING

PART No.	PLATE No.	PLATE REF.	DESCRIPTION	No. OFF		REMARKS
				R.H.D.	L.H.D.	
KL.46006	10	54	Locknut : R.H. .. .. .	2	2	
KL.46036		55	Locknut : L.H. .. .. .	2	2	
JE.621		56	Intermediate Rod .. .. .	2	2	
J.3177		57	Boot .. .. .	2	2	
J.3184			Boot Clip .. .. .	2	2	
K.18807		58	Nut for Ball Stud .. .. .	2	2	
J.4919			59	Socket Assembly : L.H. Centre Rod ..	2	2
J.4920		60	Socket Assembly : R.H. Centre Rod ..	2	2	
KL.46006			Locknut : R.H. .. .. .	2	2	
KL.46036		Locknut : L.H. .. .. .	2	2		
J.3177		57	Boot .. .. .	2	2	
J.3184			Boot Clip .. .. .	2	2	
K.18807		58	Nut for Ball Stud .. .. .	2	2	

## REAR AXLE

PART No.	PLATE No.	PLATE REF.	DESCRIPTION	No. OFF		REMARKS
				R.H.D.	L.H.D.	
<b>REAR AXLE.</b>						
400524	11		Rear Axle Assembly Complete .. ..	1		
400525			Rear Axle Assembly Complete .. ..		1	
400025		1	Rear Axle Case .. ..	1	1	
C.4858			Rear Balance Lever Bracket Bush .. ..	2	2	
FST.5/10		5	Differential to Axle Case Stud .. ..	7	7	
N.105K			Differential to Axle Case Nut .. ..	7	7	
FB.105/6			Differential to Axle Case Bolt .. ..	1	1	
$\frac{5}{16}$ " Dia. Ext.			Shakeproof Washer .. ..	8	8	
C.6393			Differential to Axle Case Joint Washer ..	1	1	
C.8982		3	Rear Axle Case Drain Plug .. ..	1	1	
C.6310		4	Oil Level Adaptor Cap .. ..	1	1	
C.7049		2	Oil Seal Rear Axle Casing .. ..	2	2	
400526			Differential Complete .. ..	1	1	Ratio 4.875-1 8/39 Teeth
<b>SERVICEABLE PARTS. DIFFERENTIAL.</b>						
C.9405 ND.		8	Pinion Housing .. ..	1	1	Moss 80309
C.9407 ND.		9	Cap Studs with Nuts .. ..	4	4	22460
C.9408 ND.		10	Locking Tabs .. ..	4	4	22473
C.9409 ND.		11	Differential Bearing .. ..	2	2	16150 x 14 —16184/4
C.9410 ND.		12	Bearing and Wheel Adjusting Shims ..	3	3	22473
C.9411 ND.		13	Differential Case .. ..	1	1	60401
C.9412 ND.		14	Differential Wheel .. ..	2	2	22403
C.9413 ND.		15	Differential Pinion .. ..	2	2	22462
C.9414 ND.		16	Differential Wheel Thrust Washer .. ..	2	2	22457
C.9415 ND.		17	Differential Pinion Thrust Washer .. ..	2	2	22461
C.9416 ND.		18	Differential Cross Pin .. ..	1	1	22459
C.9417 ND.		19	Differential Cross Pin Lock Pin .. ..	1	1	22470
400800		20	Crown Wheel } Ratio .. ..	1	1	40680/C
400801		21	Bevel Pinion } 8/39 .. ..	1	1	40681/C
C.9420 ND.		22	Crown Wheel Bolt .. ..	8	8	20102/44
C.9421 ND.		23	Locking Tabs .. ..	3	3	22471
C.9422 ND.			Locking Tabs .. ..	1	1	22472
C.9423 ND.		24	Pinion Head Bearing .. ..	1	1	2473 x 4—2420/4
C.9424 ND.		25	Pinion Tail Bearing .. ..	1	1	1986 x 4—1931/4
C.9425 ND.		26	Pinion Mesh Adjusting Shim .. ..	3	3	22469
C.9426 ND.		27	Bearing Distance Collar .. ..	1	1	22456
C.9427 ND.		28	Shim for Bearing .. ..			22464
C.9428 ND.		29	Drive Flange .. ..	1	1	22458
C.9252 ND.		30	Flange Lock Nut Slotted .. ..	1	1	21621
C.9251 ND.		31	Plain Washer .. ..	1	1	21620
C.9429 ND.		32	Pinion Housing Oil Seal .. ..	1	1	250112
C.9667 ND.		33	Oil Filler Plug .. ..	1	1	21245/5

## REAR AXLE

PART No.	PLATE No.	PLATE REF.	DESCRIPTION	NO. OFF R.H.D.	NO. OFF L.H.D.	REMARKS
<b>REAR AXLE HOUSING.</b>						
300049	11	34	Rear Hub and Shaft Assembly .. ..	2	2	
C.7975		35	Wheel Stud .. ..	8	8	
C.7976		36	Wheel Stud Nut .. ..	8	8	
300046		37	Rear Hub Bearing Housing .. ..	2	2	
Hoff. MS.11		43	Rear Hub Bearing .. ..	2	2	
300454		42	Rear Hub Oil Seal .. ..	2	2	
Tecalemit H.29			Greaser .. ..	2	2	
300044		46	Brake Drum .. ..	2	2	
CK.104/7			Brake Drum Countersunk Screw ..	4	4	
C.8880		45	Axle Shaft Hub Bearing Nut .. ..	2	2	
C.8878		44	Axle Shaft Hub Bearing Lockwasher ..	2	2	
300111		58	Rear Axle Back Plate Assembly .. ..	2	2	
FST.6/9		38	Back Plate Fixing Stud .. ..	8	8	
N.106K		39	Back Plate Fixing Nut .. ..	8	8	
$\frac{3}{8}$ " Dia. Ext.		40	Shakeproof Washer .. ..	8	8	

## BRAKES

PART No.	PLATE No.	PLATE REF.	DESCRIPTION	No. OFF		REMARKS	
				R.H.D.	L.H.D.		
<b>BALANCE LEVERS—BRAKE OPERATING RODS.</b>							
C.8509	11	47	Rear Balance Lever Assembly .. ..	1	1		
C.4858				Rear Balance Lever Bush .. ..	2	2	
C.4883			48	Dust Cover .. ..	1	1	
C.8508			50	Balance Lever Pin .. ..	1	1	
N.405K			51	Balance Lever Pin Nut .. ..	1	1	
W.105K				Washer : Balance Lever Top .. ..	1	1	
N.406K			52	Nut : Balance Lever Pin .. ..	1	1	
W.106K				Washer : Balance Lever Pin .. ..	1	1	
C.7980			49	Swivel : Rear Balance Lever .. ..	1	1	
N.105K				Nut : Rear Balance Lever .. ..	1	1	
W.105K				Washer : Rear Balance Lever .. ..	1	1	
$\frac{5}{16}$ " Dia. Ext.				Shakeproof Washer .. ..	1	1	
400055			54	Brake Operating Rod : N.S. .. ..	1	1	
400054			53	Brake Operating Rod : O.S. .. ..	1	1	
C.5009				Rubber Tube for Rod .. ..	1	1	
C.4873			55	Clevis Joint (Small) .. ..	2	2	
N.104K				Fork End and Clevis Joint Locknut ..	4	4	
C.4889			56	Clevis Pin (Short) .. ..	2	2	
W.104K		57	Washer for Clevis Pin .. ..	2	2		
<b>SERVICEABLE PARTS. FRONT BRAKES.</b>							
400664	9	66	Back Plate Assembly : L.H. .. ..	1	1	} Home Replacement only } Export Replacement only	
400684					Back Plate Assembly : R.H. .. ..		1
400669		67	Brake Shoe and Lining : L.H. .. ..	2	2		
400685				Brake Shoe and Lining : R.H. .. ..	2		2
400688			Brake Shoe and Lining : R.H. .. ..	2	2		
400682			Brake Shoe and Lining : L.H. .. ..	2	2		
400683			Brake Shoe Lining only .. ..	4	4		
400670		68	Spring Return .. ..	4	4		
400671		69	Sub-Assembly Bridge Pipe .. ..	2	2		
400672		70	Hose Assembly : 14" long .. ..	2	2		
400673		71	Wheel Cylinder Assembly : $\frac{7}{8}$ " dia. L.H.	2	2		
400686			Wheel Cylinder Assembly : $\frac{7}{8}$ " dia. R.H.	2	2		
400674		72	Wheel Cylinder Body and Abutment Strip : L.H. .. ..	2	2		
400687				Wheel Cylinder Body and Abutment Strip : R.H. .. ..	2	2	
400675		73	Wheel Cylinder Spring .. ..	4	4		
400676		74	Wheel Cylinder Air Excluder .. ..	4	4		
400677		75	Wheel Cylinder Seal .. ..	4	4		
400678		76	Wheel Cylinder Piston .. ..	4	4		
400679		77	Wheel Cylinder Dust Cap .. ..	4	4		

## BRAKES

PART No.	PLATE No.	PLATE REF.	DESCRIPTION	NO. OFF R.H.D.	NO. OFF L.H.D.	REMARKS
400680	9		Wheel Cylinder Bleed Screw .. ..	2	2	
400681			Wheel Cylinder Dust Cap .. ..	2	2	
400731			Wheel Cylinder Ball : $\frac{5}{32}$ " dia. ..	2	2	
400732			Wheel Cylinder Spring Washer .. ..	8	8	
400733			Wheel Cylinder Nut : $\frac{1}{4}$ " ANF .. ..	8	8	
<b>SERVICEABLE PARTS. REAR BRAKE.</b>						
400689	11	58	Back Plate .. ..	2	2	
400690			Rear Plate Steady .. ..	4	4	
400691			Rear Plate Felt Bush .. ..	4	4	
400727			Rear Plate Lock Nut .. ..	4	4	
400692		59	Brake Shoe and Lining .. ..	4	4	} Home Replacement only
400698	Brake Shoe and Lining .. ..		4	4	} Export Replacement only	
400699	Brake Lining only .. ..		4	4		
C.4927		65	Dust Cover .. ..	2	2	
400693			Adjuster Unit .. ..	2	2	
C.4942		61	Adjuster Unit Housing .. ..	2	2	
C.4932A			Adjuster Link : L.H. .. ..	2	2	
C.4932		63	Adjuster Link : R.H. .. ..	2	2	
C.4925			Adjuster Wedge .. ..	2	2	
400728		62	Adjuster Unit Set Bolt .. ..	4	4	
400729			Adjuster Unit Washer .. ..	4	4	
400694		64	Expander Unit .. ..	2	2	
400695			Expander Housing .. ..	2	2	
C.4945		64	Expander Tappet .. ..	4	4	
400730			Expander Tappet Split Pin .. ..	4	4	
C.4929		66	Expander Roller .. ..	4	4	
C.4944			Expander Cone .. ..	2	2	
C.4933		66	Expander Draw Link .. ..	2	2	
C.4941			Expander Draw Link Pin .. ..	2	2	
C.4943		67	Expander Draw Link Socket .. ..	2	2	
C.4928			Expander Unit Washer (Zinc) .. ..	4	4	
400726		67	Expander Unit Washer (Thackeray) .. ..	4	4	
400696			Expander Unit Nut .. ..	4	4	
400697		60	Spring : Shoe Return .. ..	4	4	

## PROPELLER SHAFT

PART No.	PLATE No.	PLATE REF.	DESCRIPTION	No. OFF R.H.D.	No. OFF L.H.D.	REMARKS
<b>PROPELLER SHAFT.</b>						
C.4820	11		Propeller Shaft .. .. .	1	1	
FB.105 7F			Propeller Shaft Bolt .. .. .	4	4	
N.105K			Propeller Shaft Nut .. .. .	4	4	
C.6304			Propeller Shaft Lockwasher .. .. .	4	4	
<b>SERVICEABLE PARTS— PROPELLER SHAFT.</b>						
K.1-2-39		69	Flange Yoke .. .. .	2	2	
K1-3-GB.18		70	Sleeve Yoke Assembly .. .. .	1	1	
K1-5-GB.58		71	Journal Assembly .. .. .	2	2	
K1-6-GB.28		72	Needle Bearing Assembly .. .. .	8	8	
94-GB.1598			Lubricator (Journal) .. .. .	2	2	
K1-7-GB.19		73	Snap Ring .. .. .	8	8	
K5-L.1			Unit Package (Consisting of Journal Assembly, 4 Bearing Race Assemblies and 4 Snap Rings (less Lubricator) ..	2	2	
K1-14GB.19		74	Dust Cap .. .. .	1	1	
K1-15-GB.13			Steel Washer .. .. .	1	1	
K1-16-GB.13			Cork Washer .. .. .	1	1	
GB.112-4331		75	Tubular Shaft Assembly .. .. .	1	1	



## CHASSIS FRAME

PART No.	PLATE No.	PLATE REF.	DESCRIPTION	No. OFF		REMARKS	
				R.H.D.	L.H.D.		
<b>FRAME ASSEMBLY.</b>							
400417	12	1	Frame Assembly .. .. .	1			
400172			Frame Assembly .. .. .		1		
400114		2	Master Cylinder .. .. .	1	1		
F.105/20			Master Cylinder Fixing Bolt .. .. .	3	3		
$\frac{5}{16}$ " Dia. Ext.			Shakeproof Washer .. .. .	2	2		
400492		3	Master Cylinder Supply Tank Complete	1	1		
300385		4	Master Cylinder Supply Tank Clip ..	1	1		
C.6312		5	Brake Pedal Return Spring .. .. .	1	1		
W.205K			Washer : Master Cylinder Fixing Bolt	1	1		
C.6654			Pipe Clip .. .. .	3	3		
RH.103/8			Screw : Pipe Clip to Frame .. .. .	3	3		
N.100K			Nut : Pipe Clip to Frame .. .. .	3	3		
$\frac{3}{16}$ " Dia. Ext.			Shakeproof Washer .. .. .	3	3		
C.6654A			Pipe Clip .. .. .	1	1		
FS.105/5			Setscrew : 3-Way Piece to Frame ..	1	1		
$\frac{5}{16}$ " Dia. Ext.			Shakeproof Washer .. .. .	1	1		
N.104K			Nut : Supply Tank to Column.. .. .	1	1		
$\frac{1}{4}$ " Dia. Ext.			Shakeproof Washer .. .. .	1	1		
<b>SERVICEABLE PARTS. MASTER CYLINDER SUPPLY TANK.</b>							
400711			3	Supply Tank (less Clip and Fixings) ..	1	1	
400712			Supply Tank Body and Cap .. .. .	1	1		
400713			Supply Tank Cap .. .. .	1	1		
400714			Supply Tank Washer .. .. .	1	1		
400715			Supply Tank Adaptor .. .. .	1	1		
400716			Supply Tank Nut .. .. .	1	1		
400735			Supply Tank Washer .. .. .	1	1		
400717			Supply Tank Gasket .. .. .	1	1		
400718			Clip : Supply Tank .. .. .	1	1		
400719			Nut : Supply Tank .. .. .	1	1		
400720			Bolt : Supply Tank .. .. .	1	1		
<b>MASTER CYLINDER (Type G.B.) SERVICEABLE PARTS.</b>							
400700		6	Master Cylinder Body .. .. .	1	1		
400701		7	Master Cylinder End Cover .. .. .	1	1		
400702		8	Master Cylinder Plunger .. .. .	1	1		
400703		9	Master Cylinder Plunger Return Spring	1	1		
400704		10	Master Cylinder Seal .. .. .	1	1		
400705		11	Master Cylinder Seal Recuperating ..	1	1		
400706		12	Master Cylinder Seal Retainer .. .. .	1	1		
400707		13	Master Cylinder Push Rod Assembly ..	1	1		

## CHASSIS FRAME

PART No.	PLATE No.	PLATE REF.	DESCRIPTION	No. OFF R.H.D.	No. OFF L.H.D.	REMARKS
✓400708	12	16	Master Cylinder Boot .. .. .	1	1	
✓400709		17	Master Cylinder Gasket .. .. .	1	1	
✓400710		18	Master Cylinder Circlip .. .. .	1	1	
400734		19	Master Cylinder Locknut .. .. .	1	1	
<b>REAR SUSPENSION—SHOCK ABSORBER.</b>						
400053		20	Rear Road Spring .. .. .	2	2	
C.5695		21	Rear Road Spring Bush .. .. .	12	12	
✓C.5603		22	Rear Road Spring Spacing Bush .. .. .	2	2	
C.5604		23	Front End Rear Spring Bolt .. .. .	2	2	
C.6399		24	Front End Rear Spring Tabwasher .. .. .	2	2	
C.6431		25	Rear Spring Shackle Plate Outer Assy. .. .. .	2	2	
C.5572		26	Rear Spring Shackle Plate Inner Assy. .. .. .	2	2	
C.5743		27	Rear Spring Shackle Plate Tabwasher .. .. .	2	2	
N.107K		28	Rear Spring Shackle Pin Nut .. .. .	4	4	
400452		29	Rear Spring Clip .. .. .	4	4	
C.6606		30	Rear Spring Packing .. .. .	2	2	
C.6574		31	Rear Spring Clip Strap .. .. .	4	4	
N.106K		32	Rear Spring Clip Nut .. .. .	8	8	
N.206K		33	Rear Spring Clip Locknuts .. .. .	8	8	
400112		34	Rear Spring Rebound Buffer (Rubber and Plate) .. .. .	2	2	
400111		35	Rear Axle Bump Rubber and Strap .. .. .	2	2	
FS.106/6			Rear Axle Bump Strap Set Pin .. .. .	4	4	
N.106K			Rear Axle Bump Strap Nut .. .. .	4	4	
$\frac{3}{8}$ " Ext. Dia.			Shakeproof Washer .. .. .	4	4	
400408		36	Rear Shock Absorber : R.H. .. .. .	1	1	
400409			Rear Shock Absorber : L.H. .. .. .	1	1	
C.8497		37	Rear Shock Absorber Link .. .. .	2	2	
FB.106/7			Rear Shock Absorber to Support Bolt .. .. .	4	4	
N.106K			Rear Shock Absorber to Support Nut .. .. .	4	4	
C.6395			Rear Shock Absorber Link Nut .. .. .	4	4	
$\frac{3}{8}$ " Dia. Ext.			Shakeproof Washer .. .. .	8	8	
<b>BRAKE DETAILS.</b>						
400082		38	Brake Pedal Assembly .. .. .	1		
C.7967			Brake Pedal Bush .. .. .	2		
C.5669A		39	Brake Pedal Rod and Pad Assembly .. .. .	1		
N.107K			Brake Pedal Nut .. .. .	2		
K.6723			Brake Pedal Rubber Tread .. .. .	1		
400077			Brake Pedal Support Pin .. .. .	1		
400073			Brake Pedal Support Pin Tabwasher .. .. .	1		

## CHASSIS FRAME

PART No.	PLATE No.	PLATE REF.	DESCRIPTION	No. OFF		REMARKS
				R.H.D.	L.H.D.	
<b>HYDRAULIC PIPES AND FITTINGS.</b>						
400497	12		Hydraulic Pipe Assembly : R.H. Front to Tee Piece .. .. .	1	1	23½" long
400721		40	Hydraulic Pipe Assembly : L.H. Front to Tee Piece .. .. .	1	1	50" long
400724		41	Hydraulic Pipe Assembly : Master Cyl. to Tee Piece .. .. .	1		12½" long
400722			Hydraulic Pipe Assembly : Master Cyl. to Tee Piece .. .. .		1	22½" long
400494		42	Hydraulic Pipe Assembly : Master Cyl. to Supply Tank .. .. .	1		26½" long
400723			Hydraulic Pipe Assembly : Master Cyl. to Supply Tank .. .. .		1	27½" long
400506			Front Hose Bracket Nut .. .. .	2	2	
400499			Banjo : Master Cyl. to 3-Way Piece ..	1	1	
400501			Banjo Bolt : Master Cyl. to 3-Way Piece	1	1	
400504			Gasket : Master Cyl. to 3-Way Piece ..	1	1	
400505			Gasket : Master Cyl. to 3-Way Piece ..	1	1	
400491			Tee Piece .. .. .	1	1	
¾" Dia. Int.			Shakeproof Washer .. .. .	2	2	
400500			Banjo : Master Cylinder to Supply Tank	1	1	
400502			Banjo Bolt : Master Cylinder to Supply Tank .. .. .	1	1	
400503			Gasket : Master Cylinder to Supply Tank .. .. .	1	1	
400505			Gasket : Master Cylinder to Supply Tank .. .. .	1	1	
<b>BRAKE REVERSING LEVER ASSY. BALANCE LEVER, ETC.</b>						
400072		43	Brake Reversing Lever Assembly ..	1		
C.8133			Brake Lever Bush .. .. .	2		
400067			Reversing Lever Pin .. .. .	1	1	
400069			Reversing Lever Tabwasher .. .. .	1	1	
400337		44	Balance Lever .. .. .	2	2	
W.106K			Balance Lever Spacing Washer ..	2	1	
400338			Balance Lever Pin .. .. .	1	1	
400341		45	Fork End Assembly .. .. .	1	1	
C.8670			Fork End Pin .. .. .	1	1	
W.105K			Fork End Washer .. .. .	1	1	
400342		46	Brake Rod Balance to Reverse Lever ..	1	1	
C.6312		47	Reversing Lever Return Spring ..	1	1	
400469		48	Reversing Lever Return Spring Anchor	2	2	
F.105/4			Set Pin : Spring Anchor to Frame ..	1		
N.105K			Nut : Spring Anchor to Frame ..	1		

## CHASSIS FRAME

PART No.	PLATE No.	PLATE REF.	DESCRIPTION	No. OFF		REMARKS
				R.H.D.	L.H.D.	
$\frac{5}{16}$ " Dia. Ext.	12		Shakeproof Washer .. .. .	1		
300325		49	Slip Link Assembly .. .. .	1	1	
N.105K			Lock Nut : Fork Ends .. .. .	3	3	
C.6451			Clevis Pin .. .. .	2	2	
W.105K			Clevis Pin Washer .. .. .	1	1	
400092			Stop Light Switch Spring Anchor ..	1	2	
Lucas 54C			Stop Light Switch and Spring ..	1	1	
RH.103/8			Stop Light Switch Fixing Screw ..	2	2	
N.100K			Stop Light Switch Fixing Nuts ..	2	2	
$\frac{3}{16}$ " Dia. Ext.			Shakeproof Washer .. .. .	2	2	
<b>HAND BRAKE LEVER ASSEMBLY HAND BRAKE ASSEMBLY.</b>						
400079		50	Handbrake Lever Assembly .. .. .	1		
400078			Handbrake Lever Support Pin .. ..	1	1	
Tecalemit H.29			Greaser .. .. .	1	1	
400073			Tabwasher .. .. .	1	1	
C.4226		51	Handbrake Complete with Fixing Bolts and Cable C10322 .. .. .	1	1	
C.6782			Hand Brake Support Bracket .. ..	1	1	
FS.104/4			Handbrake Support Bracket Set Pin ..	1	1	
N.104K			Handbrake Support Bracket Nut .. ..	1	1	
$\frac{1}{4}$ " Dia. Ext.			Shakeproof Washer .. .. .	1	1	
400076		52	Brake Rod : Handbrake to Reversing Lever .. .. .	1	1	
300325		53	Slip Link Assembly .. .. .	1	1	
C.6506		54	Fork End .. .. .	1	1	
C.6451			Clevis Pin .. .. .	2	2	
W.105K			Clevis Pin Washer .. .. .	2	2	
C.6312		55	Brake Pedal Return Spring .. .. .	1	1	
C.6636		56	Brake Pedal Return Anchor .. .. .	1	1	
<b>BRAKE COUPLING LEVER— BRAKE RODS AND FITTINGS.</b>						
300331		57	Brake Coupling Lever Assembly ..	1	1	
C.4858			Brake Coupling Lever Bush .. .. .	2	2	
C.5684			Brake Coupling Lever Pin .. .. .	1	1	
W.105K			Brake Coupling Lever Pin Washer ..	1	1	
N.405K			Brake Coupling Lever Pin Nut .. ..	1	1	
400093		58	Brake Rod : Reversing Lever to Coup- ling Lever .. .. .	1	1	
400094		59	Brake Rod : Coupling Lever to Rear Axle .. .. .	1	1	
300329		60	Brake Rod Fork End .. .. .	1	1	
C.4873		61	Brake Rod Fork End .. .. .	3	3	

## CHASSIS FRAME

PART No.	PLATE No.	PLATE REF.	DESCRIPTION	No. OFF R.H.D.	No. OFF L.H.D.	REMARKS
C.4867	12	62	Universal Clevis Joint .. .. .	1	1	
C.6451			Clevis Pin .. .. .	4	4	
C.4889			Clevis Pin .. .. .	2	2	
W.105K			Clevis Pin Washer .. .. .	1	1	
W.104K			Clevis Pin Washer .. .. .	4	4	
N.104K			Locknut for Brake Rods .. .. .	4	4	
C.5009			63	Rubber Tube for Brake Rod .. .. .	1	1
<b>BRAKE AND CLUTCH PEDAL ASSEMBLIES AND SHAFT, L.H.D.</b>						
400189			Brake Pedal Assembly .. .. .		1	
C.7967			Brake Pedal Bush .. .. .		2	
400195			Clutch and Brake Pedal Shaft .. .. .		1	
400321			Brake Pedal Rod Assembly .. .. .		1	
N.107K			Brake Pedal Nut .. .. .		2	
C.6723			Brake Pedal Rubber Tread .. .. .		1	
400191			Clutch Pedal Assembly .. .. .		1	
Tecalemit NA.5792/1			Greaser .. .. .		1	
<b>CLUTCH PEDAL ROD &amp; BRAKE. OPERATING LEVER ASSEMBLIES L.H.D.</b>						
C.5669A			Clutch Pedal Rod Assembly .. .. .		1	
N.107K			Clutch Pedal Nut .. .. .		2	
C.6723			Clutch Pedal Rubber Tread .. .. .		1	
400476			Brake Operating Lever Assembly .. .. .		1	
C.7967			Brake Operating Lever Bush .. .. .		1	
C.6445			Pedal Shaft Spacing Washer .. .. .		2 or 3	As required
W.205K			Pedal Shaft Retaining Washer .. .. .		1	
FS.105/4			Pedal Shaft Retaining Set Pin .. .. .		1	
$\frac{5}{16}$ " Dia. Ext.			Shakeproof Washer .. .. .		1	
C.7967			Pedal Shaft Support Bush : Sidemember .. .. .		1	
400547			Pedal Shaft Support Bush : Sub-Frame .. .. .		2	
400395			Clutch Operating Lever Assembly .. .. .		1	
Tecalemit NA.5701			Greaser .. .. .		1	
No. $5 \times 1\frac{1}{4}$ "			Taper Pin .. .. .		2	
400300			Brake Reversing Lever Assembly .. .. .		1	
C.8133			Brake Reversing Lever Bush .. .. .		2	
C.8141			Clutch Pedal Coupling Rod Assembly .. .. .		1	
C.6349			Clutch Pedal Coupling Rod Spring .. .. .		1	
C.6403			Spherical Nut .. .. .		1	
N.205K			Locknut .. .. .		3	
W.206K			Washer .. .. .		1	

## CHASSIS FRAME

PART No.	PLATE No.	PLATE REF.	DESCRIPTION	NO. OFF R.H.D.	NO. OFF L.H.D.	REMARKS
C.6451	12		Clevis Pin .. .. .		1	
W.105K			Washer .. .. .		1	
FS.105/8			Pedal Stop Plate Set Pin .. .. .		1	
N.105K			Pedal Stop Plate Nut .. .. .		1	
400295			Handbrake Lever Assembly .. .. .		1	
<b>EXHAUST SYSTEM.</b>						
400158		64	Silencer Assembly Complete with Front and Rear Exhaust Pipe .. .. .	1	1	
C.4118		65	Silencer Barrel Assembly .. .. .	1	1	
400156		66	Front Exhaust Pipe .. .. .	1	1	
400157		67	Rear Exhaust Pipe .. .. .	1	1	
C.2676		68	Silencer Clip .. .. .	1	1	
C.5839		69	Silencer Clip Support .. .. .	1	1	
C.5695		70	Silencer Clip Support Bush .. .. .	1	1	
FB.105/8		71	Silencer Clip Support Bolt .. .. .	1	1	
N.105K			Silencer Clip Support Nut .. .. .	1	1	
$\frac{5}{16}$ " Dia. Ext.			Shakeproof Washer .. .. .	1	1	
C.5837		72	Silencer Support Brackets .. .. .	2	2	
C.5840		73	Silencer Support Bracket Pin .. .. .	1	1	
W.205K			Silencer Support Bracket Washer .. .. .	1	1	
N.405K			Silencer Support Bracket Nut .. .. .	1	1	
FS.105/5			Silencer Support Bracket to Frame Set Pin .. .. .	2	2	
N.105K			Silencer Support Bracket to Frame Nut .. .. .	2	2	
$\frac{5}{16}$ " Dia. Ext.			Shakeproof Washer .. .. .	2	2	
C.8361		74	Front Exhaust Pipe Gasket .. .. .	1	1	
N.105BR			Exhaust System to Manifold Nut .. .. .	4	4	
$\frac{5}{16}$ " Dia. Ext.			Shakeproof Washer .. .. .	4	4	
C.7033		75	Rear Exhaust Pipe Clip .. .. .	1	1	
FB.105/4			Rear Exhaust Pipe Clip Set Pin .. .. .	1	1	
N.105K			Rear Exhaust Pipe Clip Nut .. .. .	2	2	
FB.105/6			Rear Exhaust Pipe Clip Bolt .. .. .	1	1	
<b>PETROL TANK ASSEMBLY PIPES AND FITTINGS.</b>						
400426		76	Petrol Tank Assembly .. .. .	1	1	
C.6421			Petrol Tank Support Bracket : N.S. .. .. .	1	1	
C.6422			Petrol Tank Support Bracket : O.S. .. .. .	1	1	
C.6423			Petrol Tank Support Bracket : Rear .. .. .	1	1	
C.6635			Drain Plug .. .. .	1	1	
C.6350			Petrol Tank Washer : Drain Plug .. .. .	1	1	
Jaeger TA.110		77	Petrol Gauge Complete with Joint .. .. .	1	1	
RH.103/6			Petrol Gauge Fixing Screw .. .. .	6	6	
C.7084			Petrol Tank Fixing Screw Washer .. .. .	6	6	

## CHASSIS FRAME

PART No.	PLATE No.	PLATE REF.	DESCRIPTION	NO. OFF		REMARKS	
				R.H.D.	L.H.D.		
C.3727	12		Petrol Gauge Mounting Rubber ..	3	3		
W.206K			Petrol Tank Mounting Washer ..	3	3		
C.7232			Petrol Tank Mounting Tabwasher ..	3	3		
FB.106/8			Petrol Tank Mounting Bolts ..	3	3		
400428			Petrol Pipe Assembly Tank to Pump ..	1	1		
400424			Flex : Pump to Carburettor .. ..	1	1		
C.6654			Petrol Pipe Clip .. .. .	6	6		
RH.103/8			Petrol Pipe Clip Screw .. .. .	5	5		
N.100K			Petrol Pipe Clip Nut .. .. .	5	5		
$\frac{3}{16}$ " Dia. Ext.			Shakeproof Washer .. .. .	6	6		
B.7571		78	Filler Neck Grommet .. .. .	1	1		
C.9097		79	Filler Neck Extension Assembly ..	1	1		
C.6876		80	Filler Cap .. .. .	1	1		
C.9053		81	Filler Neck Extension Hose .. ..	1	1		
C.6224		82	Filler Neck Extension Hose Clip ..	2	2		
<b>PETROL PUMP AND FIXINGS.</b>							
C.6244	13		Petrol Pump Complete with Unions ..	1	1		
FST.4/16			Petrol Pump Stud .. .. .	2	2	Up to Chassis 4AD 1001U	
FST.4/11			Petrol Pump Stud .. .. .	2	2	After 4AD 1001U	
C.6708			Petrol Pump Packing Piece .. .. .	1	1		
C.6709			Petrol Pump Plate .. .. .	1	1		
400751			Petrol Pump Packing Piece (Plywood) ..	2	2	1 off after Chassis 4AD 1001U	
N.104K			Petrol Pump Stud Nut .. .. .	2	2		
W.204K			Petrol Pump Stud Washer .. .. .	2	2		
<b>SERVICEABLE PARTS FOR PETROL PUMP.</b>							
405			1	Fibre Washer : $\frac{1}{4}$ " Gas Inlet Union ..	1	1	
839		2	Valve Disc .. .. .	2	2		
840		3	Spring Retainer Clip : Valve Disc ..	1	1		
847		4	5 BA Brass Screw for Spring Blade ..	1	1		
868		5	5 BA Spring Washer: Spring Blade Screw	1	1		
869		6	Moulded Terminal Knob .. .. .	1	1		
878		7	2 BA Brass Terminal Nut .. .. .	2	2		
887		8	Gas Double Ended Inlet Union .. ..	1	1		
4080/1		9	Body Casting (Aluminium) .. .. .	1	1		
4081/1		10	Plate Casting (Aluminium) .. .. .	1	1		
4082/1		11	Gasket .. .. .	1	1		
1416		12	Valve Cage .. .. .	1	1		
1421		13	Filter Plug .. .. .	1	1		
1422		14	Outlet Union .. .. .	1	1		

## CHASSIS FRAME

PART No.	PLATE No.	PLATE REF.	DESCRIPTION	No. OFF		REMARKS	
				R.H.D.	L.H.D.		
AS.1430	13	15	Solenoid Complete in Housing—12 volt	1	1		
1433		16	Roller : Diaphragm .. .. .	11	11		
1435		17	Rocker Arm Pin .. .. .	1	1		
AS.1438		18	Contact Set (Single Point) Earth Return	1	1		
1442		19	Fibre Washer Filter and Outlet Union	2	2		
1449		20	Armature Spring .. .. .	1	1		
4083		21	Long Coil Housing Fixing Screw ..	5	5		
1455		22	5 BA Terminal Tag .. .. .	1	1		
1456		23	2 B.A. Terminal Tag .. .. .	4	4		
1459		24	2 BA End Plate Moulding Fixing Screw	2	2		
AS.1464		25	Filter .. .. .	1	1		
1466 12v		26	End Cover Cap (Black) 12v. .. ..	1	1		
1467		27	End Plate Moulding .. .. .	1	1		
1468		28	Terminal Screw .. .. .	1	1		
1479		29	Fibre Washer : Valve Cage .. .. .	1	1		
1661		30	Brass 2 BA Cone Nut for Lead Ring ..	1	1		
1662		31	Lead Contact Ring for Terminal ..	1	1		
4084		32	Long Earth Stud for Aluminium Body ..	1	1		
AS.1697		33	Diaphragm and Spindle Assembly ..	1	1		
1863		34	2 BA Spring Washer : Terminal Nut and End Plate Washer .. .. .	4	4		
<b>RADIATOR AND CONNECTIONS, ETC.</b>							
400167	14	1	Radiator Block Assembly less Drain Tap	1	1		
C.9227		2	Radiator Drain Tap .. .. .	1	1		
C.8307		3	Top Water Connection .. .. .	1	1	will Service C.8307	
C.10277			Top Water Connection .. .. .	1	1		
C.6222		4	Top Water Connection Clip .. .. .	2	2		
400346		5	Bottom Water Connection .. .. .	1	1		
C.6223		6	Bottom Water Connection Clip .. ..	2	2		
C.6860		7	Pad : Radiator Block to Frame .. ..	4	4		
$\frac{7}{16}$ " B.S.F. GKN. LA1		8	Nut : Radiator Block to Frame .. ..	2	2		
400580		9	Radiator Stay Assembly : R.H. .. ..	1	1		
400581			Radiator Stay Assembly : L.H. .. ..	1	1		
N.104K			Stay Assembly to Case Nut .. .. .	2	2		
$\frac{1}{4}$ " Dia. Ext.			Shakeproof Washer .. .. .	2	2		
AC1571315		10	Filler Cap : Pressure Type .. .. .	1	1		
<b>ROAD WHEELS.</b>							
400440	12	83	Road Wheels, Tyres and Tubes, 5.00×16	5	5		
400416			Road Wheels .. .. .	5	5		
C.9748		84	Wheel Discs .. .. .	4	4		



## ELECTRICAL EQUIPMENT

PART No.	PLATE No.	PLATE REF.	DESCRIPTION	NO. OFF R.H.D.	NO. OFF L.H.D.	REMARKS
<b>ELECTRICAL EQUIPMENT INSTRUMENTS.</b>						
Jaeger P.112			Combined Ammeter, Oil and Petrol Gauge with Lucas Ammeter C.Z.20 ..	1	1	Metric
Jaeger *34006A			Ditto .. .. .	1	1	
*998462			Lighting Switch PLC.6 Type L.106 ..	1	1	
WB.5468C			Panel Connector .. .. .	1	1	
*031069A			Ignition Switch Lock and Keys ..	1	1	
*314124			Ignition Warning Light .. .. .	1	1	
*764401B/ 764428B			Panel Light Switch .. .. .	1	1	
F.218			Starter Switch and Coupling ST.19/1 ..	1	1	
F.225			Speedometer Cable 5 ft. 7 in. ..	1		
FB.104/10			Speedometer Cable 5 ft. .. .. .		1	
$\frac{1}{4}$ " Dia. Ext.			Speedo. Pinion Guide to Cable Bolt ..	1	1	
*31260			Shakeproof Washer .. .. .	1	1	
*052626			Hand Dipper Switch .. .. .	1	1	
*069213E			Stop Tail Lamp ST.488 .. .. .	2	2	
FS.104/4			Horn HF.1235 .. .. .	1	1	
N.104K			Horn to Bracket Set Pin .. .. .	2	2	
$\frac{1}{4}$ " Dia. Ext.			Horn to Bracket Nut .. .. .	2	2	
*732687H			Shakeproof Washer .. .. .	2	2	
*733480			Windscreen Wiper CW1 Type BP73 ..	1	1	
			Windscreen Wiper Arm and Blade Assy. : L.H. .. .. .	1	1	
*733479			Windscreen Wiper Arm and Blade Assy. : R.H. .. .. .	1	1	
*76216A			Horn Push HP.19 .. .. .	1	1	
Jaeger SS.579			Speedometer .. .. .	1	1	
Jaeger SS.579K			Speedometer .. .. .	1	1	
C.5068G			Choke Control BP/14C/K48 .. .. .	1	1	
C.9577			Starter Control BP/95/K49 .. .. .	1	1	
*186111			Battery Fixing Screw .. .. .	2	2	
*4011500F			Battery CTW7A .. .. .	1	1	
*524887			Sidelamps LD.109 .. .. .	1 pr.	1 pr.	
C.9117			Headlamp Bracket : L.H. .. .. .	1	1	
C.9118			Headlamp Bracket : R.H. .. .. .	1	1	
C.6700			Headlamp Grommet. .. .. .	2	2	
FB.105/6			Headlamp Bracket Bolt .. .. .	4	4	
N.105K			Headlamp Bracket Nut .. .. .	4	4	
$\frac{5}{16}$ " Dia. Ext.			Shakeproof Washer .. .. .	4	4	
C.6637			Sidelamp Grommet through Valance ..	2	2	
B.6203			Sidelamp Grommet .. .. .	2	2	
C.5509			Sidelamp Weather Grommet .. .. .	2	2	
*37138			Control Box RB.106 .. .. .	1	1	
*37132D			Fuse Unit SF.106 .. .. .	1	1	
*Lucas Accessories						

## ELECTRICAL EQUIPMENT

PART No.	PLATE No.	PLATE REF.	DESCRIPTION	No. OFF	No. OFF	REMARKS
				R.H.D.	L.H.D.	
*052448D			Number Plate Lamp 467A .. ..	1	1	
3" x 4 BA			Cheese Head Screws (Stop Tail Lamp)	6	6	
*820220			Harness Cable .. ..	1	1	
*860459			Petrol Pump Feed Lead .. ..	1	1	
*860458			Petrol Pump Earth Lead .. ..	1	1	
*859426A			Screen Wiper Cable .. ..	1		
*859426B			Screen Wiper Cable .. ..		1	
<b>SERVICEABLE PARTS — WIND-SCREEN WIPER.</b>						
				R.H.D.	L.H.D.	
*732480			Wiper Motor .. ..	1	1	
*730467			Cover Assembly .. ..	1	1	
*730388			Brush Set .. ..	1	1	
*733108			Armature .. ..	1	1	
*735168			Arm : R.H. .. ..	1	1	
*735167			Arm : L.H. .. ..	1	1	
*732693			Bar Coupling .. ..	1	1	
*727707			Wiper Blade .. ..	2	2	
*731721			Bearing Set .. ..	1	1	
<b>HEADLAMPS.</b>						
*056290A			<b>Headlamp S.700</b> , Bulb No. 300 Dip Left <i>For</i> Cyprus, Iceland, Nyasaland, Sudan, Tanganyika, Aden, Bermuda, Jamaica, Malta, Uganda, Hong-Kong, Shanghai, Malay, Straits Settlements, Australia, South Africa, New Zealand, Burma, India.	2		Service No. 50869A Up to Chassis 4AD 29U
*056302A			<b>Headlamp S.700</b> Bulb No. 301, Dip Right <i>For</i> Syria, Algeria, Egypt, Iran, Suad Arabia, Chile, Spain, South America, Eritrea, Ethiopia, Israel, Gibraltar, Canada, Denmark, Greece, Austria, Netherlands, East Indies, Lebanon, Sweden.			Service No. 50869A Up to Chassis 4AD 29U
*056307			<b>Headlamp S.700</b> , Bulb No. 350, Dip Vertical .. .. <i>For</i> Finland, Holland, Hungary, Norway, Switzerland, Germany, Belgium, Czecho-Slovakia, Italy, Portugal.		2	Service No. 50869A Up to Chassis No. 4AD 29U
*056308			Headlamp S.700, Bulb No. 301, Dip Right <i>For</i> U.S.A., Ecuador (not California)		2	Service No. 50877 Up to Chassis 4AD 29U
*Lucas Accessories						

## ELECTRICAL EQUIPMENT

PART No.	PLATE No.	PLATE REF.	DESCRIPTION	No. OFF R.H.D.	No. OFF L.H.D.	REMARKS
*056290A			<b>Headlamp S.700</b> , No Bulb, Dip Vertical (3 Pin Adaptors) . . . . . <i>For France, French Morocco, Tunisia</i>		2	Service No. 50876A Up to Chassis 4AD 29U
*056291A			<b>Headlamp S.700</b> , N.S. Double Filament, Dip Left, Bulb No. 300 . . . . .	1		Service No. 50869A Up to Chassis 4AD 29U
*056487 *056489			<b>Headlamp S.700</b> , O.S. Single Filament Bulb No. 162 . . . . . <i>For Great Britain and Eire . . . . .</i>		1	Service No. 50870A Up to Chassis 4AD 29U
			<b>Headlamps S.700</b> , Body and Rim only, Plus Special Leads 553724, Cardboard Filling, Disc 553712 and Spring Clips <i>For California only.</i>		2	
			<b>Headlamp S.700</b> , Block Type Lens Bulb No. 354, RHD, Double Dip Left With Silvered Reflectors . . . . . With Aluminised Reflectors . . . . . <i>For Australia, British East Africa, British West Africa, Ceylon, Channel Islands, Cyprus, Gibraltar, Hong-Kong, India, Irish Republic, Malta, Mauritius, New Zealand, Pakistan, S. Rhodesia, Union of S. Africa, Great Britain.</i>	2		From Chassis 4AD 30U
*056308A *056490			<b>Headlamp S.700</b> , Block Type Lens, Bulb No. 301, LHD, Double Dip Right . . With Silvered Reflectors . . . . . With Aluminised Reflectors . . . . . <i>For Argentine, Bermuda, Brazil, British West Indies, Canada, Iran, Iraq, Israel, Siam (Thailand), U.S.A., Uruguay, Venezuela.</i>		2	From Chassis No. 4AD 30U
*056488 *056491			<b>Headlamp S.700</b> Block Type Lens, Bulb No. 360, LHD, Double Dip Centre . . With Silvered Reflectors . . . . . With Aluminised Reflectors . . . . . <i>For Belgium, Canary Islands, Denmark, Dutch East Indies, Egypt, Finland, Germany, Morocco, Netherlands, Norway, Portugal, Spain, Switzerland, Sweden, Turkey.</i>		2	From Chassis No. 4AD 30U
*Lucas Accessories						

## ELECTRICAL EQUIPMENT

PART No.	PLATE No.	PLATE REF.	DESCRIPTION	No. OFF R.H.D.	No. OFF L.H.D.	REMARKS
<b>SERVICEABLE PARTS S.700 HEADLAMPS.</b>						
*553248			Rim Assembly .. .. .	2	2	} Up to Chassis No. 4AD 29.U
*553921			Light Unit .. .. .	2	2	
*553774			Light Unit .. .. .	2	2	
*504665			Wire : Light Unit Fixing .. .. .	2	2	
*859696			Adaptor .. .. .	2	2	
*552915			Gasket Body .. .. .	2	2	
*522906			Excluder : Rubber .. .. .	2	2	
			Bulb as Fitted .. .. .	2	2	
<b>SERVICEABLE PARTS S.700 BLOCK TYPE LENS HEADLAMP</b>						
*553935			Reflector Unit (Quote R.H.D. or L.H.D.			
*552912			Front Rim Assembly .. .. .			
*552395			Bulb Holder Assembly .. .. .			
			Bulb as in Headlamp Specification			
<b>SERVICEABLE PARTS FOR SIDELAMP.</b>						
*521989			Rim Assembly less Glass .. .. .			
*571211			Glass .. .. .			
*522869			Wire Set : Reflector Fixing .. .. .			
*207			Bulb .. .. .			
<b>SERVICEABLE PARTS—STOP TAIL LAMP.</b>						
*572734			Rim .. .. .			
*572704			Lens .. .. .			
*188818			Sleeve : Terminal .. .. .			
*572703			Body : Rubber .. .. .			
*552101			Interior : Bulbholder .. .. .			
<b>SERVICEABLE PARTS—NUMBER PLATE. NUMBER PLATE ILLUMINATION.</b>						
*572616			Body .. .. .			
*572596			Window .. .. .			
*572595			Gasket .. .. .			
*572039			Grommet : Cable .. .. .			
*5772588			Set of Sundries .. .. .			
*Lucas Accessories						

## ELECTRICAL EQUIPMENT

PART No.	PLATE No.	PLATE REF.	DESCRIPTION	No. OFF R.H.D.	No. OFF L.H.D.	REMARKS
<b>SERVICEABLE PARTS— REGULATOR BOX.</b>						
391600			Cover .. .. .	1	1	
334906			Clip .. .. .	1	1	
334977			Resistance .. .. .	1	1	
33143A			Regulator .. .. .	1	1	
187022			Eyelet .. .. .	1	1	
101544			Screw, 2 BA .. .. .	1	1	
185029			Spring Washer .. .. .	1	1	
121614			Terminal Screw .. .. .	5	5	
<b>SERVICEABLE PARTS— FUSEBOX.</b>						
188219			Fuse : 50 Amp. .. .. .	4	4	
<b>OIL PRESSURE PIPES AND WIRING CLIPS.</b>						
400457			Flex to Gauge Oil Pressure Pipe Assy.	1	1	
C.7084			Oil Pipe Union Washer .. .. .	2	2	
C.10138			Oil Pipe to Engine Case Flex .. .. .			
*187085			Wiring Clip : Front Wing Support Stay .. .. .	2	2	
*187085			Wiring Clip : Dash Panel .. .. .	2	2	
*187081			Wiring Clip : Steering Box .. .. .	1	1	
*187033			Wiring Clip : Bonnet Side to Flitch ..	6	6	
*187033			Wiring Clip : Flitch to Chassis .. .. .	1	1	
*187033			Wiring Clip : Screen to Rail .. .. .	1	1	
*187012			Wiring Clip : Deck Board Batten .. .. .	1	1	
*187051			Wiring Clip : Tool Deck Ply (Underside)	2	2	
*850882			Wiring Clip (Bowden) : Steering Column	1	1	
*187048			Wiring Clip : Tail Lamp Cable .. .. .	1		
*187093			Wiring Clip : Chassis Harness to Frame	6	6	
C.6523			Wiring Clip : Chassis Harness to Frame	1	1	
RH.103/8			Clip Fixing Screw .. .. .	1		
N.100K			Clip Fixing Nut .. .. .	1		
$\frac{3}{16}$ " Dia. Ext.			Shakeproof Washer .. .. .	1		
C.10449			Clip : Oil Gauge Flex .. .. .	1	1	
*Lucas Accessories						

## CHASSIS FITTINGS

PART No.	PLATE No.	PLATE REF.	DESCRIPTION	No. OFF		REMARKS
				R.H.D.	L.H.D.	
<b>ACCELERATOR PEDAL DETAILS AND FIXINGS.</b>						
400583	12	85	Accelerator Control Shaft Assembly ..	1		
400334				Accelerator Control Shaft Assembly ..		1
400645		86	Accelerator Control Shaft Spring ..	1	1	
FB.104/9				Accelerator Control Shaft Bolt ..	3	3
FB.104/10			Accelerator Control Shaft Bolt ..	1	1	
N.104K			Accelerator Control Shaft Nut ..	4	4	
$\frac{1}{4}$ " Dia. Ext.			Shakeproof Washer .. ..	4	4	
400353			Accelerator Cable Assembly .. ..	1	1	
C.5475			Accelerator Cable Swivel Pin .. ..	1	1	
W.103K			Accelerator Cable Swivel Pin Washer ..	2	2	
N.100K			Accelerator Cable Swivel Pin Nut .. ..	1	1	
400453			Accelerator Cable Ferrule .. ..	1	1	
N.106K			Accelerator Cable Ferrule Nut .. ..	1	1	
$\frac{3}{8}$ " Dia. Ext.			Shakeproof Washer .. ..	1	1	
RH.103/10			Accelerator Cable Clip Screw .. ..	1	1	
N.100K			Accelerator Cable Clip Nut .. ..	1	1	
$\frac{3}{16}$ " Dia. Ext.			Shakeproof Washer .. ..	1	1	
C.7808A			Ball Joint : Accelerator Cable .. ..	1	1	
N.100K			Ball Joint Locknut .. ..	1	1	
$\frac{3}{16}$ " Dia. Ext.			Shakeproof Washer .. ..	1	1	
C.6491			Carburettor Return Spring .. ..	1	1	
C.8493			Accelerator Return Spring Bracket ..	1	1	
<b>FRONT BUMPERS—NUMBER PLATE.</b>						
400602			Front Bumper and Number Plate Assy.	1	1	
400594			Front Bumper Blade and Bracket Assy.	1	1	
400595			Blade Complete with Bolts, Nuts and Washers .. ..	1	1	
400596			Front Bumper Bracket .. ..	2	2	
C.3806			Front Number Plate .. ..	1	1	
W.106K			Front Number Plate Spacing Washer ..	4	4	
400600			Packing Piece .. ..	2	2	
FB.107/10D			Bumper Bracket and Wing Stay to Frame Bolt .. ..	2	2	
FB.107/7D			Bumper Bracket to Frame Bolt .. ..	2	2	
W.107K			Front Bracket to Frame Washer .. ..	2	2	
$\frac{7}{16}$ " Dia. Ext.			Shakeproof Washer .. ..	4	4	
<b>REAR BUMPERS.</b>						
400624N.D.			Rear Bumper Assembly .. ..	1	1	
400570			Rear Bumper Blade .. ..	1	1	

## CHASSIS FITTINGS

PART No.	PLATE No.	PLATE REF.	DESCRIPTION	No. OFF		REMARKS
				R.H.D.	L.H.D.	
400571			Rear Bumper Reinforcement Bar ..	1	1	
C.5841			Rear Bumper Blade Bolt .. ..	3	3	
N.106K			Rear Bumper Blade Nut .. ..	3	3	
$\frac{3}{8}$ " Dia. Ext.			Shakeproof Washer .. ..	3	3	
C.7046	12	87	Rear Bumper Bracket Assy. : L.H. ..	1	1	
C.7047			Rear Bumper Bracket Assy. : R.H. ..	1	1	
400575			Bumper Blade to Bracket Bolt .. ..	2	2	
400577			Bumper Blade to Bracket Distance Piece	2	2	
N.106K			Bumper Blade to Bracket Nut .. ..	2	2	
$\frac{3}{8}$ " Dia. Ext.			Shakeproof Washer .. ..	2	2	
FB.105/7			Rear Bumper Bracket to Frame Bolt ..	4	4	
FB.105/6			Rear Bumper Bracket Bolt .. ..	2	2	
$\frac{5}{16}$ " Dia. Ext.			Shakeproof Washer .. ..	6	6	
<b>FRONT WINGS, BONNET SIDES AND LOUVRES—STEPBOARDS.</b>						
400137			Front Wing : L.H. .. ..	1	1	
400138			Front Wing : R.H. .. ..	1	1	
400511			Bonnet Side Complete with Louvres and Slats : L.H. .. ..	1	1	
400512			Bonnet Side Complete with Louvres and Slats : R.H. .. ..	1	1	
C.4546			Louvre Assembly : L.H. .. ..	1	1	
C.4547			Louvre Assembly : R.H. .. ..	1	1	
400400			Fixed Bonnet Side Stay Bracket : L.H.	1	1	
400401			Fixed Bonnet Side Stay Bracket : R.H.	1	1	
400303			Lock : L.H. .. ..	1	1	
400304			Lock : R.H. .. ..	1	1	
400305			Lock Escutcheon .. ..	2	2	
026468			Buffer .. ..	8	8	
RK.103/8C			Raised Countersunk Screw .. ..	4	4	
N.100K			Nut .. ..	4	4	
$\frac{3}{16}$ " Dia. Ext.			Shakeproof Washer .. ..	4	4	
<b>FRONT WING STAYS AND FLITCH ASSEMBLY.</b>						
400226			Front Wing Stay : L.H. .. ..	1	1	
400227			Front Wing Stay : R.H. .. ..	1	1	
FS.106/6			Bolt : Front Wing Stay to Front Flitch	2	2	
W.206K			Washer : Front Wing Stay to Front Flitch	4	4	
$\frac{3}{16}$ " Dia. Ext.			Shakeproof Washer .. ..	2	2	
N.106K			Nut : Front Wing Stay to Front Flitch	2	2	
400229			Front Flitch Assembly : L.H. ..	1	1	
400230			Front Flitch Assembly : R.H. ..	1	1	
FS.104/6			Front Flitch to Frame Set Pin ..	6	6	

## CHASSIS FITTINGS

PART No.	PLATE No.	PLATE REF.	DESCRIPTION	No. OFF R.H.D.	No. OFF L.H.D.	REMARKS
W.104K			Front Flitch to Frame Washer .. ..	6	6	
$\frac{1}{4}$ " Dia. Ext.			Shakeproof Washer .. ..	6	6	
RH.103/8			Screw : Front Valance to Wing .. ..	2	2	
N.100K			Nut : Front Valance to Wing .. ..	2	2	
$\frac{3}{16}$ " Dia. Ext.			Shakeproof Washer .. ..	2	2	
400228			Screw : Bonnet Side to Bonnet Landing	6	6	
C.7243ND			Flitch Packing .. ..	2	2	
FS.104/4			Set Pin : Bonnet Side to Flitch .. ..	10	10	
N.104K			Nut : Bonnet Side to Flitch .. ..	12	12	
W.204K			Washer : Bonnet Side to Flitch .. ..	12	12	
$\frac{1}{4}$ " Dia. Ext.			Shakeproof Washer .. ..	12	12	
2BA/B4			Set Pin : Bonnet Side to Flitch and Valance .. ..	4	4	
N.100K			Nut : Bonnet Side to Flitch and Valance	4	4	
W.103K			Washer .. ..	4	4	
400261			Channel Reinforcement : Front Flitch	2	2	
400399			Fixed Bonnet Side Stay .. ..	2	2	
FS.105/5			Fixed Bonnet Side Stay Set Pin .. ..	4	4	
$\frac{5}{16}$ " Dia. Ext.			Shakeproof Washer .. ..	4	4	
FS.104/4			Fixed Bonnet Side Stay to Wing Set Pin	4	4	
N.104K			Fixed Bonnet Side Stay to Wing Nut ..	4	4	
$\frac{1}{4}$ " Dia. Ext.			Shakeproof Washer .. ..	4	4	
400402			Reinforcement : Bonnet Side Dash Top : L.H. .. ..	1	1	
400403			Reinforcement : Bonnet Side Dash Top : R.H. .. ..	1	1	
No. 4 $\times$ $\frac{1}{4}$ " P.K.			Screws : Reinforcement .. ..	4	4	
400425			Wing Stay Packing .. ..	2	2	
FS.104/4			Set Pin : Front Wing and Bonnet Side Assembly .. ..	12	12	
W.204K			Washer : Front Wing and Bonnet Side Assembly .. ..	12	12	
FS.104/5			Set Pin : Bonnet Side to Flitch and Radiator Stay .. ..	2	2	
FS.106/5			Set Pin : Front Wing Stay Fixing .. ..	4	4	
W.206K			Washer : Front Wing Stay Fixing .. ..	4	4	
$\frac{3}{8}$ " Dia. Ext.			Shakeproof Washer .. ..	4	4	
400237			Stepboard Assembly : L.H. .. ..	1	1	
400238			Stepboard Assembly : R.H. .. ..	1	1	
400239			Stepboard Capping Front End .. ..	2	2	
C.5396			Stepboard Tread : Short .. ..	2	2	
C.5397			Stepboard Tread : Long .. ..	2	2	
B.8166			Stepboard Tread End Ferrule .. ..	8	8	
FB.105/6			Bolt : Stepboard To Wing : Front .. ..	4	4	
N.105K			Nut : Stepboard to Wing : Front .. ..	4	4	
W.205K			Washer : Stepboard to Wing : Front ..	4	4	
<b>REAR WINGS.</b>						
400448			Rear Wing : L.H. .. ..	1	1	
400449			Rear Wing : R.H. .. ..	1	1	



## CHASSIS FITTINGS

PART No.	PLATE No.	PLATE REF.	DESCRIPTION	NO. OFF		REMARKS	
				R.H.D.	L.H.D.		
<b>RADIATOR CASE.</b>							
400203	14	11	Radiator Case Complete Assembly ..	1	1		
400242		12	Radiator Case Plating Assembly (Less Grille Slats) .. .. .	1	1		
400247	13	13	Radiator Grille Assembly .. .. .	1	1		
C.6914			Radiator Grille Bottom Pad .. .. .	1	1		
400597			Clip Landing to Radiator Case .. .. .	2	2		
RH.103/6C	22		Fixing Screw .. .. .	2	2		
N.100K			Fixing Nut .. .. .	2	2		
$\frac{3}{16}$ " Dia. Ext.			Shakeproof Washer .. .. .	2	2		
C.3836E			Radiator Name Plate with Fixings .. .. .	1	1		
C.6913			Radiator Grille Top Pad .. .. .	1	1		
RH.103/4C			Fixing Screw : Grille to Case .. .. .	6	6		
N.100K			Fixing Nut : Grille to Case .. .. .	6	6		
$\frac{3}{16}$ " Dia. Ext.			Shakeproof Washer .. .. .	6	6		
C.5348		23	23	Radiator Motif .. .. .	1	1	
CK.103/12				Radiator Motif Fixing Screw .. .. .	2	2	
N.100K			Radiator Motif Fixing Nut .. .. .	2	2		
$\frac{3}{16}$ " Dia. Ext.			Shakeproof Washer .. .. .	2	2		
400275			Radiator Case Bottom Bracket .. .. .	1	1		
RH.103/8			Radiator Case Bottom Bracket Screw .. .. .	4	4		
$\frac{3}{16}$ " Dia. Ext.			Shakeproof Washer .. .. .	4	4		
FB.104/6			Bolt : Radiator Case Btm. Bkt. to Frame .. .. .	2	2		
N.104K			Nut : Radiator Case Btm. Bkt. to Frame .. .. .	2	2		
$\frac{1}{4}$ " Dia. Ext.			Shakeproof Washer .. .. .	2	2		
400161			Front Valance .. .. .	1	1		
No. 11 $\times$ $\frac{7}{16}$ "			Bifurcated Rivets .. .. .	2	2		
<b>BONNET LANDING.</b>							
400206				Bonnet Landing Assembly .. .. .	1	1	
400208			Bonnet Landing to Rad. Case Assy. L.H. .. .. .	1	1		
400209			Bonnet Landing to Rad. Case Assy. R.H. .. .. .	1	1		
400272			Bonnet Rest Rubber .. .. .	1	1		
C.5025			Bonnet Rest Bracket .. .. .	2	2		
CK.104/11			Bonnet Rest Bracket Screw .. .. .	2	2		
N.104K			Nut : Landing to Radiator Case .. .. .	2	2		
No. 4 $\times$ $\frac{1}{2}$ " P.K.			Fixing Screw : Rest Rubber .. .. .	4	4		
$\frac{1}{4}$ " Dia. Ext.			Shakeproof Washer .. .. .	2	2		
<b>BONNET TOP.</b>							
400276			Bonnet Top Assembly Complete .. .. .	1	1		
400446			Bonnet Top Assembly : L.H. .. .. .	1	1		
400447			Bonnet Top Assembly : R.H. .. .. .	1	1		
400319			Bonnet Lock Striker Plate : L.H. .. .. .	1	1		
400320			Bonnet Lock Striker Plate : R.H. .. .. .	1	1		
C.5226A			Bonnet Hinge Centre .. .. .	1	1		

## CHASSIS FITTINGS

PART No.	PLATE No.	PLATE REF.	DESCRIPTION	No. OFF		REMARKS
				R.H.D.	L.H.D.	
<b>TOOLS.</b>						
400363			Starting Handle .. .. .	1	1	
C.4657			Pliers .. .. .	1	1	
C.9880 N.D.			Tyre Inflator .. .. .	1	1	
C.6558 N.D.			Distributor Spanner .. .. .	1	1	
C.6547D			Wheel Brace .. .. .	1	1	
C.7040 N.D.			$\frac{5}{16}$ " - $\frac{3}{8}$ " Open-ended Spanner .. .. .	1	1	
C.6562 N.D.			Tyre Lever .. .. .	2		
C.6373			Tappet Spanner .. .. .	1	1	
C.9752 N.D.			Grease Gun .. .. .	1	1	
C.7476 N.D.			Tyre Valve Extractor .. .. .	1	1	
C.7475 N.D.			Tyre Valve Split Ring .. .. .	1	1	
C.7778 N.D.			Tyre Lever : 6 $\frac{1}{2}$ " .. .. .	1	1	
C.6622			Oiling Funnel .. .. .	1	1	
C.6551			Screwdriver : 4" .. .. .	1	1	
C.6552			82/.92" Box Spanner .. .. .	1	1	
C.6553 N.D.			60/.71" Box Spanner .. .. .	1	1	
C.6554 N.D.			445/.525" Box Spanner .. .. .	1	1	
C.6555 N.D.			Tommy Bar for Box Spanners .. .. .	1	1	
C.7053			Tool Bag Assembly .. .. .	1	1	
B.6751			"L" Key : Trunk Lid .. .. .	1	1	
C9708			Screw Type Jack .. .. .	1	1	
C.6550 N.D.			Medium Adjustable Spanner .. .. .	1	1	
<b>OPTIONAL EXTRAS</b>						
400749			Front Bumper Over-rider Assembly .. .. .	2	2	
400750			Rear Bumper Over-rider Assembly .. .. .	2	2	
*54039A			Trafficators SF.34L .. .. .	1 pr.	1 pr.	
*538316			Trafficators Fixing Brackets .. .. .	2	2	
*100034			Trafficators Fixing Brackets Screws .. .. .	2	2	
*188333			Trafficators Fixing Brackets Washers .. .. .	2	2	
Lucas 31359A			Trafficators Switch .. .. .	1	1	
Lucas 860577			Trafficators Earth Wire .. .. .	1	1	
Lucas 850103			Trafficators Switch Wire : L.H. .. .. .	1	1	
Lucas 851103			Trafficators to Switch Wire R.H. .. .. .	1	1	
Lucas 860578			Trafficators Switch to Fuse Box Wire .. .. .	1	1	
<b>BODY</b>						
B.9741A			Body Shell Assembly .. .. .	1		
B.9741B			Body Shell Assembly .. .. .		1	
B.9021			Back Lid Assembly .. .. .	1	1	
B.9215A			Boot and Quarter Panel Assembly .. .. .	1	1	
B9743			Scuttle Panel Assembly .. .. .	1	1	
B.7832			Quadrant Assembly : Trunk Lid N.S. .. .. .	1	1	

## BODY

PART No.	PLATE No.	PLATE REF.	DESCRIPTION	No. OFF		REMARKS
				R.H.D.	L.H.D.	
B.7833			Quadrant Assembly : Trunk Lid O.S.	1	1	
B.9062			Spare Wheel Pan Shield Assembly ..	1	1	
B.8774			Scuttle Side Panel Assembly : O.S. ..	1		
B.8774A			Scuttle Side Panel Assembly : N.S. ..		1	
B.9935			Scuttle Side Panel Assembly : N.S. ..	1		
B.9936			Scuttle Side Panel Assembly : O.S. ..		1	
B7185			Spare Wheel Panel Assembly .. ..	1	1	
B.9271			Spare Wheel Tray Assembly .. ..	1	1	
B.8490			Wheel Arch Panel Assembly : N.S. ..	1	1	
B.8491			Wheel Arch Panel Assembly : O.S. ..	1	1	
B.9067			Dash Rail Assembly .. ..	1	1	
B.7166A			Seat Pan .. ..	1	1	
B.8493			Top Water Channel .. ..	1	1	
B.8706			Side Water Channel : N.S. .. ..	1	1	
B.8707			Side Water Channel : O.S. .. ..	1	1	
B.8479			Quarter Panel : Front N.S. .. ..	1	1	
B.8480			Quarter Panel : Front O.S. .. ..	1	1	
B.7229			Top Rail Panel .. ..	1	1	
B.9854			Tool Deck Panel Assembly .. ..	1		
B.9855			Tool Deck Panel Assembly .. ..		1	
<b>DOORS.</b>						
B.9035			Door Assembly : N.S. .. ..	1	1	
B.9036			Door Assembly : O.S. .. ..	1	1	
B.7227			Door Panel : N.S. .. ..	1	1	
B.7228			Door Panel : O.S. .. ..	1	1	
B.8833			Door Casing Assembly : O.S. .. ..	1	1	
B.8834			Door Casing Assembly : N.S. .. ..	1	1	
<b>DOOR HINGES—LOCKS— HANDLES.</b>						
B.9735			Door Hinge : Top N.S. .. ..	1	1	
B.9736			Door Hinge : Top O.S. .. ..	1	1	
B.9737			Door Hinge : Bottom N.S. .. ..	1	1	
B.9738			Door Hinge : Bottom O.S. .. ..	1	1	
CK.104/28			Screw : Door Hinge .. ..	8	8	
N.104K			Nut : Door Hinge .. ..	8	8	
W.204K			Washer : Door Hinge .. ..	8	8	
B.9739			Trunk Lid Hinge : N.S. .. ..	1	1	
B.9740			Trunk Lid Hinge : O.S. .. ..	1	1	
B.7262			Door Lock Complete : N.S. .. ..	1	1	
B.7263			Door Lock Complete : O.S. .. ..	1	1	
BD.1182×5A			Buffer Striking Plate .. ..	4	4	
026670			Budget Lock Boot Lid : O.S. .. ..	1	1	
026671			Budget Lock Boot Lid : N.S. .. ..	1	1	

## BODY

PART No.	PLATE No.	PLATE REF.	DESCRIPTION	No. OFF		REMARKS
				R.H.D.	L.H.D.	
BD.334 × 5			Budget Lock Plate .. .. .	2	2	
B.6320			Buffer : Trunk Lid .. .. .	2	2	
B.6390			Washer : Trunk Lid Buffer .. .. .	2	2	
BD.1182 × 5A			Striking Plate : Trunk Lid Buffer .. .. .	2	2	
B.6090B			Outside Door Handle : O.S. .. .. .	1	1	
B.6090A			Outside Door Handle : N.S. .. .. .	1	1	
B.9609			Striker Plate .. .. .	2	2	
BD.1080 × 4A			Door Buffer .. .. .	4	4	
BD.1050 × 4B			Door Buffer Plate .. .. .	4	4	
B.9195			Door Draught Excluder .. .. .	2	2	
B.9047			Grab Handle .. .. .	1	1	
B.6093			Inside Door Handle .. .. .	2	2	
B.6389			Inside Door Handle Grub Screw .. .. .	2	2	
B.9017			Trap Cover : Spare Wheel Tray .. .. .	1	1	
1/4" × No. 6			Round Head Oxidised Parker Kalon Screws .. .. .	3	3	
B.8469A			Footwells, Tunnel and Heelboard Assy.	1	1	
BD.3459 × 4			Trap Cover : Seat Pan .. .. .	1	1	
3/8" × No. 8			Round Head Oxidised Parker Kalon Screws .. .. .	1	1	
<b>MOUNTING.</b>						
B.9032			Rear Mounting Bracket Assembly : N.S.	1	1	
B.9033			Rear Mounting Bracket Assembly : O.S.	1	1	
FB.104/5			Bolt : Mounting Bracket .. .. .	4	4	
N.104K			Nut : Mounting Bracket .. .. .	4	4	
BD.3397 × 4			Body Mounting Pad .. .. .	10	10	
FB.106/10			Bolt : Rear Mounting .. .. .	2	2	
FB.106/17			Bolt : Bottom Side Mounting .. .. .	2	2	
FB.106/18			Bolt : Front and Inter Mounting .. .. .	4	4	
Simmonds NP/F/124			Nut .. .. .	8	8	
W.106K			Washer .. .. .	8	8	
C.6396			Washer .. .. .	8	8	
FB.104/6			Bolt : Tie Rod to Chassis .. .. .	2	2	
1/4" Dia. Ext.			Shakeproof Washer .. .. .	2	2	
N.105K			Nut : Tie Rod Stud .. .. .	4	4	
B.9838			Toeboard Strap Assembly .. .. .	1	1	
B.9835			Toeboard Strap Assembly N/S .. .. .	1	1	
B.9836			Toeboard Strap Assembly O/S .. .. .	1	1	
B.10033			Bonnet Rest Rubber .. .. .	1	1	
B.9926			Number Plate Bracket Assembly Rear	1	1	
B.9975			Cable Clip : Rear Number Plate .. .. .	1	1	
026896			Grommet : Rear Number Plate Cable .. .. .	1	1	
026894			Grommet : Stop Tail Lamp Cable .. .. .	2	2	

## BODY

PART No.	PLATE No.	PLATE REF.	DESCRIPTION	No. OFF R.H.D.	No. OFF L.H.D.	REMARKS
<b>WINDSCREEN.</b>						
B.9839			Windscreen Assembly .. .. .	1	1	} Special Export Orders
B.9839A			Windscreen Assembly (Laminated Glass)	1	1	
B.9840A			Windscreen Glass .. .. .	1	1	
B.9840			Windscreen Glass .. .. .			
B.9716			Stanchion Assembly : N.S. .. .. .	1	1	
B.9717			Stanchion Assembly : O.S. .. .. .	1	1	
B.9720			Thumb Screw : Stanchion .. .. .	2	2	
B.9721			Dome Nut : Stanchion .. .. .	2	2	
B.9722			Swivel Pins .. .. .	2	2	
B.9723			Swivel Pin Washer .. .. .	2	2	
B.9724			Swivel Pin Chamfer Washer (Thumb Screw) .. .. .	2	2	
B.9817			Clips : Cable .. .. .	4	4	
BD.3813A/4			Screw : Cable Clip .. .. .	4	4	
<b>SEATS.</b>						
B.9902			Rear Cushion Complete Assembly ..	1	1	
B.9905			Rear Squab Complete Assembly ..	1	1	
B.9861			Front Seat Assembly .. .. .	2	2	
B.9862			Front Seat Squab .. .. .	2	2	
B.9863			Front Seat Cushion Assembly .. ..	2	2	
B.9886			Front Seat Hinge Link .. .. .	4	4	
B.9256			Front Seat Hinge Bolt .. .. .	4	4	
N.105K			Front Seat Hinge Nut .. .. .	4	4	
W.105K			Front Seat Hinge Washer .. .. .	8	8	
B.9942			Front Seat Hinge Brkt. Assembly : L.H.	2	2	
CK.104/20			Screw .. .. .	20	20	
B.9943			Front Seat Hinge Brkt. Assembly : R.H.	2	2	
B.9972			Washer .. .. .	4	4	
BD.3273 × 2			Sliding Seat Fitting Assembly .. ..	2	2	
BD.3273 × 2A			R.H. Slide : Top .. .. .	2	2	
BD.3273 × 2B			R.H. Slide : Bottom .. .. .	2	2	
BD.3273 × 2C			L.H. Slide : Top .. .. .	2	2	
BD.3273 × 2D			L.H. Slide : Bottom .. .. .	2	2	
<b>FLOORBOARDS.</b>						
B.9756			Floorboard : Front N.S. .. .. .	1		
B.9756A			Floorboard : Front N.S. .. .. .		1	
B.9757			Floorboard : Front O.S. .. .. .	1	1	
B.9758B			Toeboard : Top .. .. .	1		
B.9758A			Toeboard : Top .. .. .		1	
B.9759			Toeboard : Bottom .. .. .	1		
B.9759A			Toeboard : Bottom .. .. .		1	

## BODY

PART No.	PLATE No.	PLATE REF.	DESCRIPTION	No. OFF		REMARKS
				R.H.D.	L.H.D.	
CK.104/15			Screw .. .. .	6	6	
CK.104/17			Screw .. .. .	12	11	
B.6110			Washer .. .. .	22	21	
<del>B.9760</del>	<i>obsolete</i>		<del>Gearbox Cover .. .. .</del>	<del>1</del>	<del>1</del>	
No. 8			Chrome Cup Washers .. .. .	11	11	
B.8474			Telegauge Cover .. .. .	1	1	
$\frac{1}{2}$ " x No. 8			Round Head Parker Kalon Screws ..	2	2	
<b>CARPETS AND TREAD PLATES.</b>						
B.9227			Floor Carpet Assembly : O.S. ..	1		L.H.D. B.9227A
B.9228			Floor Carpet Assembly : N.S. ..	1		L.H.D. B.9228A
B.8797			Tunnel Carpet .. .. .	1	1	
B.9230			Toeboard Carpet Assembly .. .. .	1		L.H.D. B.9230A
B.8801			Floor Underfelt : N.S. .. .. .	1	1	
B.8802			Floor Underfelt : O.S. .. .. .	1	1	
B.8803			Toeboard Underfelt .. .. .	1	1	
B.8532A			Floorboard Felt .. .. .	1	1	
Carr 75/203			Carpet Fastener .. .. .	28	28	
Carr 541A			Pronged Ring : Floor Carpet ..	2	2	
Carr 541			Socket : Floor Carpet .. .. .	2	2	
Carr 757/1			Stud .. .. .	2	2	
B.7180A			Tread Plate : N.S. .. .. .	1	1	
B.7181A			Tread Plate : O.S. .. .. .	1	1	
<b>HOOD.</b>						
B.8949			Hood Assembly .. .. .	1	1	
Carr 680			Lift-the-Dot Stud .. .. .	10	10	
Carr 609			Lift-the-Dot Socket .. .. .	14	14	
Carr 708A			Lift-the-Dot Clinch Plate .. .. .	14	14	
Carr 671-548-457			Press Studs (Complete Sets) ..	6	6	
B.8191			No. 1 and 3 Hoodstick Assembly ..	1	1	
B.8196			No. 2 Hoodstick Assembly .. .. .	1	1	
B.9302			Tonneau Cover Assembly .. .. .	1		
B.9302A			Tonneau Cover Assembly .. .. .		1	
<b>SIDE SCREENS.</b>						
B.9968			Side Screen Assembly : O.S. (Glass) ..		1	} Special Export only
B.9978			" " " O.S. (Glass) ..	1		
B.9977			Side Screen Assembly : N.S. (Glass) ..		1	} Standard
B.9964			Side Screen Assembly : N.S. (Glass) ..	1		
B.9800			Side Screen Assembly : N.S. (Celluloid)	1		

## BODY

PART No.	PLATE No.	PLATE REF.	DESCRIPTION	No. OFF R.H.D.	No. OFF L.H.D.	REMARKS
B.9800A			Side Screen Assembly : N.S. (Celluloid)		1	Standard
B.9801			Side Screen Assembly : O.S. (Celluloid)	1		
B.9801A			Side Screen Assembly : O.S. (Celluloid)		1	
Carr 671-548-457			Press Studs : Side Screen Flaps (Com- plete sets) .. .. .	2	2	
B.7211			Front Bracket : Side Screen .. ..	2	2	
B.7212			Rear Bracket : Side Screen N.S. ..	1	1	
RK.103/5C			Screw .. .. .	4	4	
B.8647			Windscreen Bracket : Side Screen N.S.	1	1	
R.103/5C			Screw .. .. .	2	2	
<b>MISCELLANEOUS.</b>						
B.7091C			Luggage Strap .. .. .	2	2	
B.7090E			Luggage Strap .. .. .	2	2	
BD.1242 × 1			Driving Mirror .. .. .	1	1	
BD.9714			Driving Mirror Bracket .. .. .	1	1	

EDWARDS THE PRINTERS LTD., COVENTRY





